



PLASPEN®

**P 222 RAIL SERIES
PVC PROFILE SYSTEM**



TECHNIC

P 222 RAIL SERIES

Profile Width: 63 mm double rail frame, 111 mm triple rail frame and 38 mm sliding system sash profile.

Number of chambers: 3

Profile Class: B Class (TS EN 12608-1)

Seal Type: The installed bristle wick system

Glass Thickness (mm): 4-6, 15, 17 mm

- 1** Frame with fly-screen and sill option
- 2** Triple rail sash option
- 3** Single and double glass option.

INSTRUCTION

- 63 mm double rail, 111 mm triple rail, 38 mm sliding sash profile.
- Perfect thermal, sound and water isolation because of the 3 chambers system.
- Application of single glaze 4-6 mm and installation glass 15, 17 mm by grey sealed glazing beads in different thickness.
- Application with roller shutter and without roller shutter.
- Wooden designed laminated applications.

LAMINATED COLORS

				
GOLDEN OAK ST 500	DARK OAK ST 501	SWAMP OAK ST 503	LIGHT OAK ST 515	GREY SAND AS 509
				
GREY ST 507	ANT. GREY ST 508	ANT. GREY AS 508	MAHOGANY ST 504	CREAM AS 057

P 222 RAIL SERIES

PVC PROFILE SYSTEM

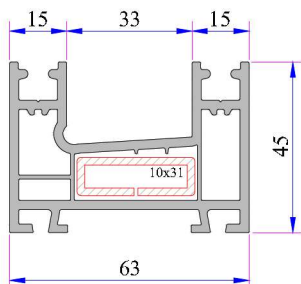

Frame Profile (Double Rail)
Code: P.A.222.1100.600.0.00.03

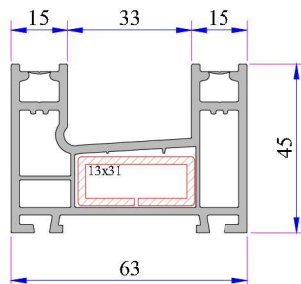

New Frame Profile (Double Rail)
Code: P.A.222.1111.600.0.00.03

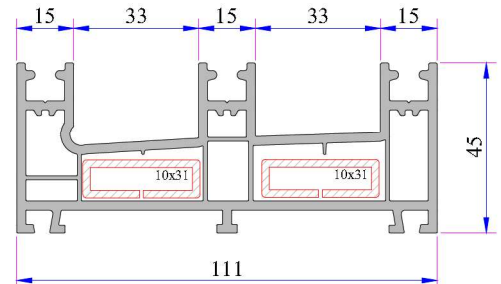

Frame Profile (Triple Rail)
Code: P.A.222.1103.600.0.00.03

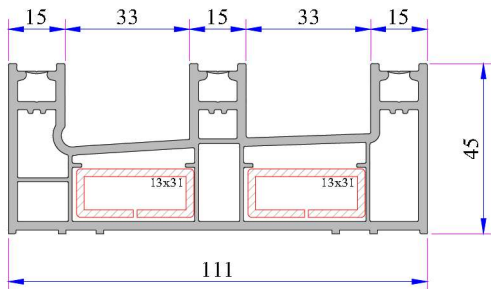

New Frame Profile (Triple Rail)
Code: P.A.222.1112.600.0.00.03

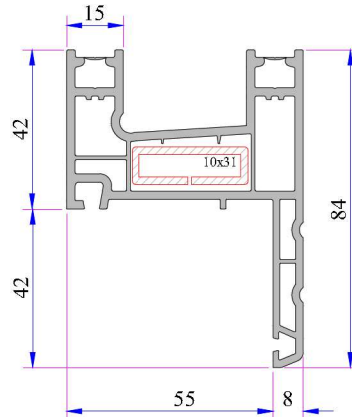

Frame With Flat-Sill Profile
Code: P.A.222.1107.600.0.00.03

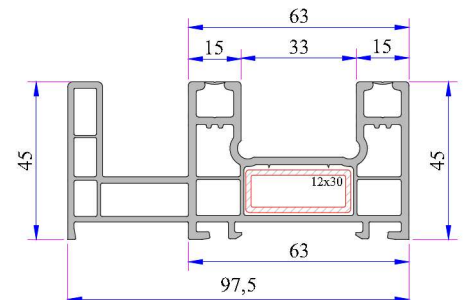

Frame With Fly-Screen
Code: ???

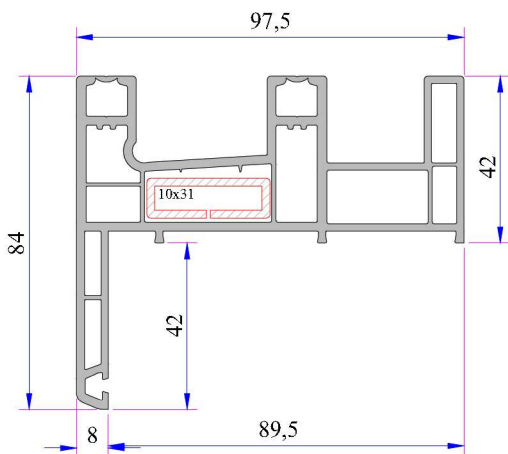

Frame With Fly-Screen&Sill
Code: P.A.222.1109.600.0.00.03

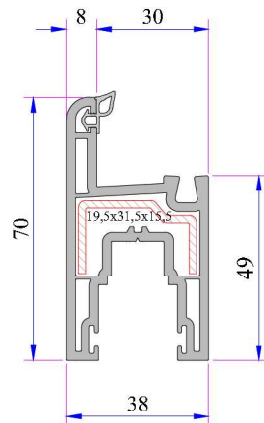

Sliding System Sash Profile
Code: P.A.222.2300.600.0.BC.03

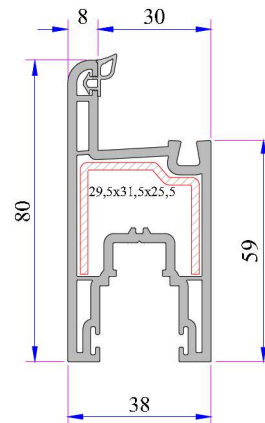

Super Sliding System Sash Profile
Code: P.A.222.2304.600.0.BC.03

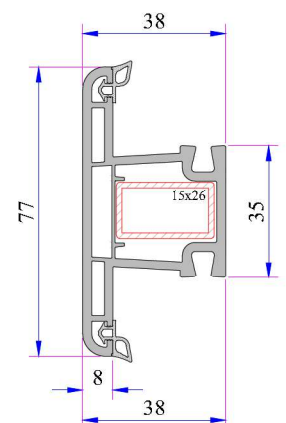

Mullion Profile for Sash Profile
Code: P.A.222.3201.600.0.BC.03

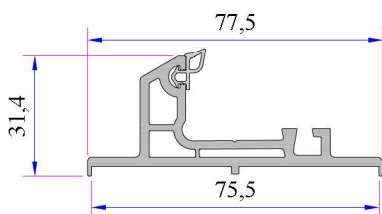

Double Rail Adaptor Profile
Code: P.A.232.5800.600.0.BC.19

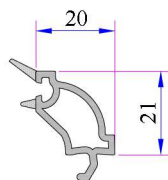

Single Glazing Bead 4-6 mm
Code: P.A.101.4102.600.0.HC

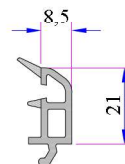

Double Glazing Bead 15 mm
Code: P.A.532.4400.600.0.HC

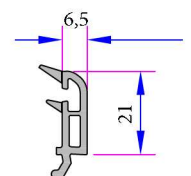

Double Glazing Bead 17 mm
Code: P.A.532.4500.600.0.HC

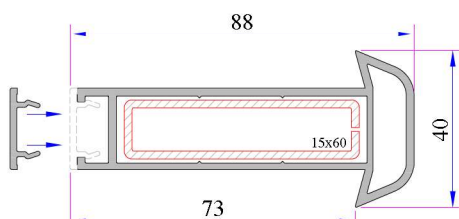

Universal Large Coupling Profile
Code: P.A.058.5000.600.0.19



Universal Large Coupling Cover Profile
Code: P.A.900.5705.600

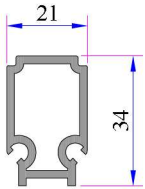

**Alm. Double Sash
Adaptor Profile**
Code: AD16-011

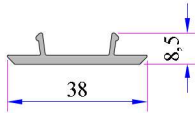

**Screen Sash Cover
Profile**
Code:
P.A.222.5704.600

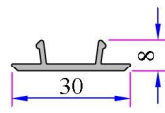

**Screen Sash Cover
Profile**
Code:
P.A.242.5701.600

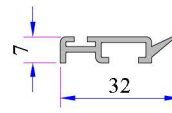

Lap Strip Profile
Code:
P.A.232.5801.600

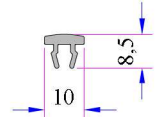

**Frame Channel Cover
Profile**
Code:
P.A.232.5703.600

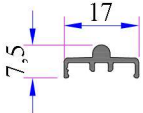

Alm. Sliding Rail Profile
Code: ???



Alm. Sliding Rail Profile
Code: AD16-014

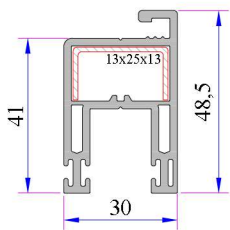

Sliding System Sash Profile
Code:
P.A.242.2305.600.0.00.03

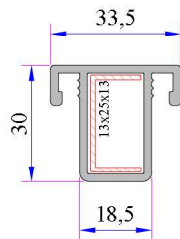

Screen Mullion Profile
Code:
P.A.242.3200.600.0.00.03

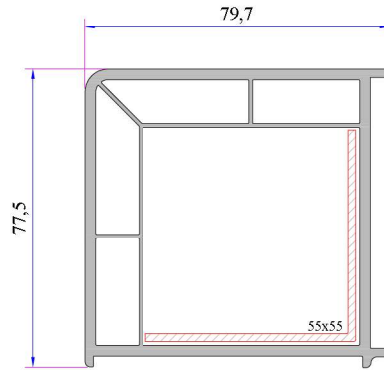

Corner Profile (90°)
Code: P.A.070.5100.600.0.00.19

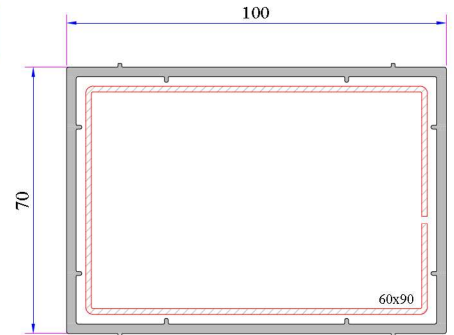

Box Profile (70*100)
Code: P.A.070.5202.600.0.00.19

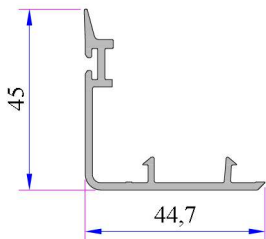

PVC Super Sash Cover Profile
Code: P.A.222.5700.600.0.00.19

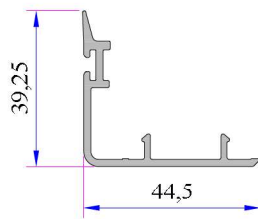

PVC Sash Cover Profile
Code: P.A.222.5708.600.0.00.19

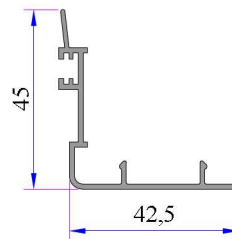

Alm. Sash Cover Profile
Code: AD16-032

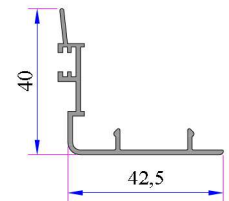

Alm. Super Sash Cover Profile
Code: AD16-031

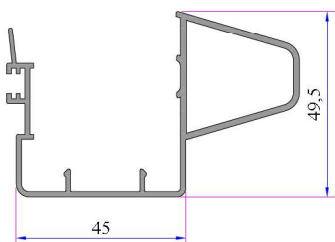

**Alm. Sash Cover Grillage Profile
(In Process)**

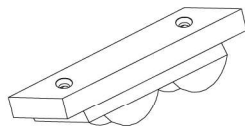

Sliding Roller Brass
Code: 34009-18030

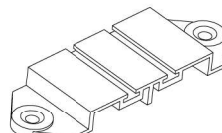

Sealing Bit Double Rail
Code: 34009-27010

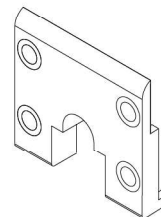

Sliding Sash End Bit
Code: 34009-47010

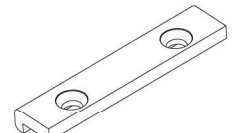

**Upper Bedding Piece for
Sliding Rail**
Code: 34009-37010

P 222 Re-Inforcement Profiles

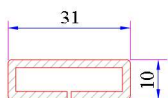

**Triple Rail Frame - Frame With
Flat-Sill Profile - Frame With Fly-
Screen&Sill Profile Reinforcement**
Code: 34022-12107

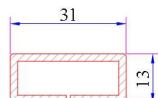

**New Frame Profile (Double Rail)-
New Frame Profile (Triple Rail)
Profile Reinforcement**
Code: 34022-12126

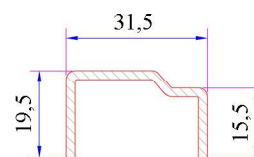

**Sliding System Sash Profile
Reinforcement**
Code: 34022-15026

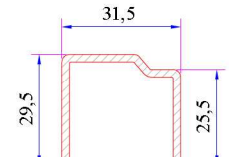

**Super Sliding System Sash Profile
Reinforcement**
Code: 34022-15027

P 222 RAIL SERIES

PVC PROFILE SYSTEM

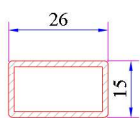

Mullion Profile for Sash
Code: 34022-12127



Universal Large Coupling Profile
Code: 34022-12123

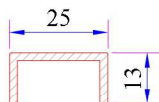

Sliding System Sash-Mullion Profile
Reinforcement
Code: 34022-12008

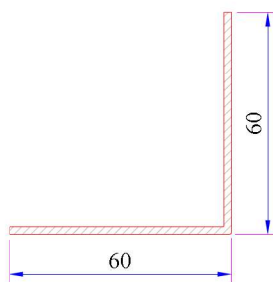

90° Corner Profile
Reinforcement
Code: 34022-12306

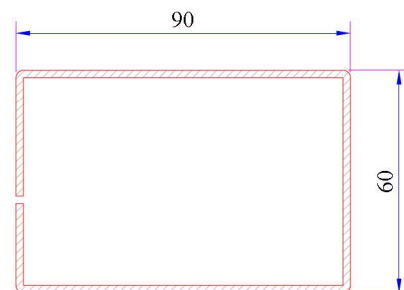

Box Profile Reinforcement
Code: 34022-12121

P 222 Installation

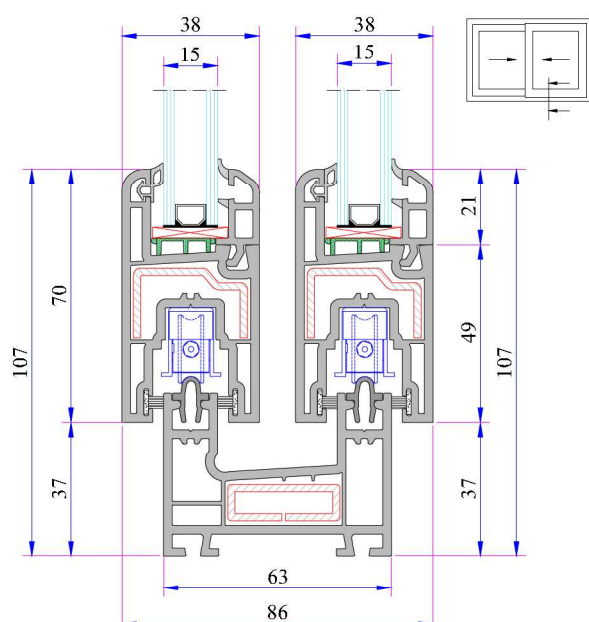

Double Rail Frame - Sliding System
Sash Profile Installation

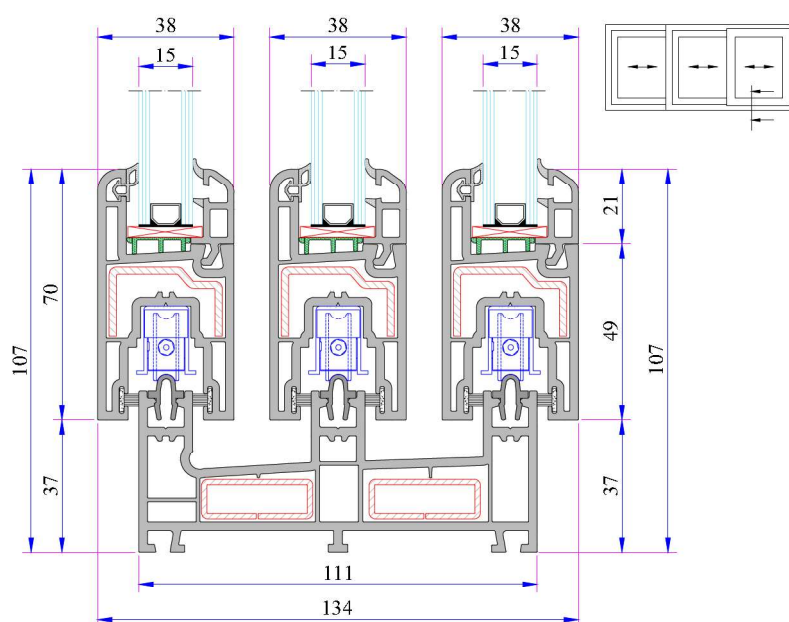

Triple Rail Frame - Sliding System Sash
Profile Installation

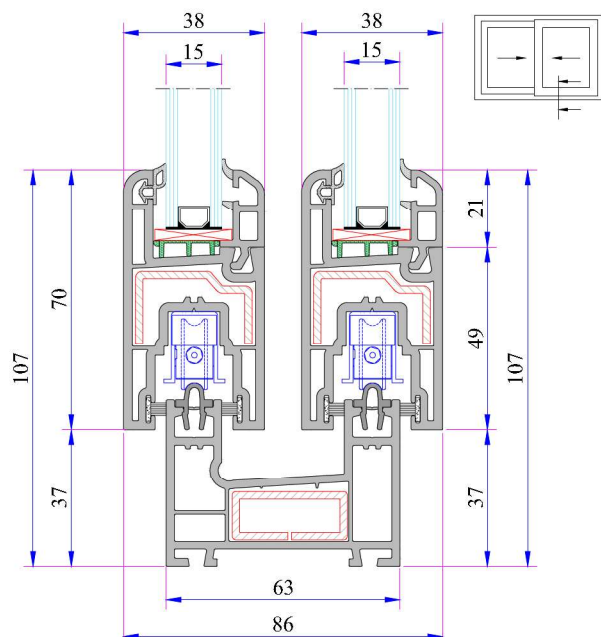

Double Rail Frame(New) - Sliding
System Sash Profile Installation

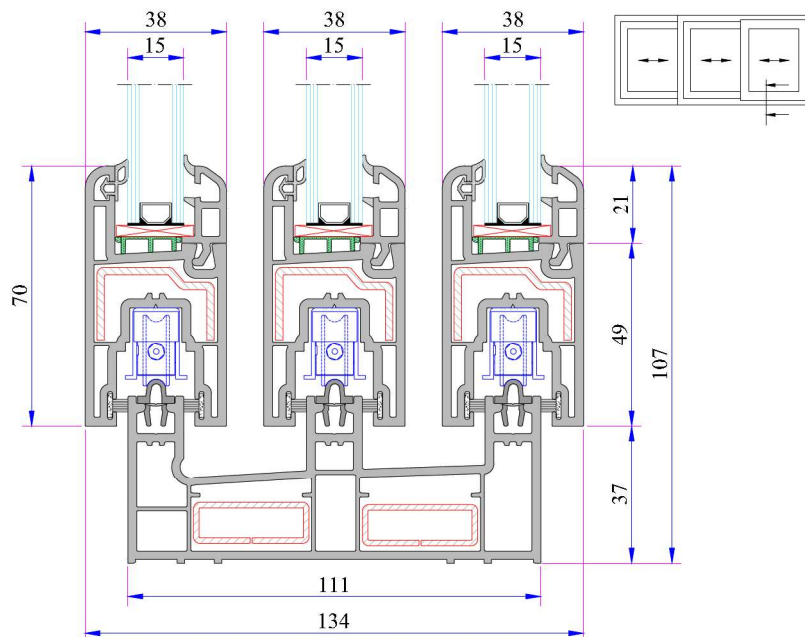

Triple Rail Frame (New) - Sliding
System Sash Profile Installation

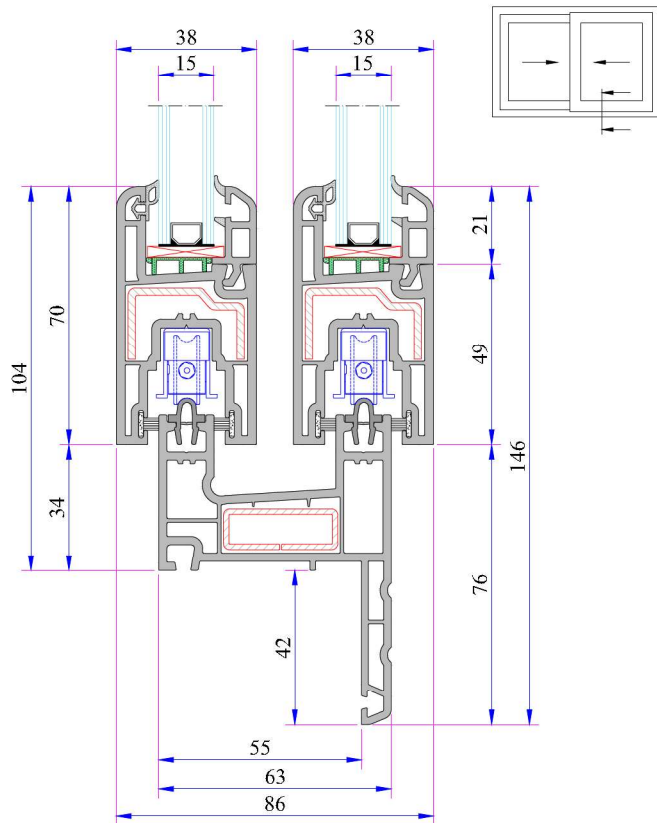

Double Rail Frame with Sill - Sliding
System Sash Profile Installation

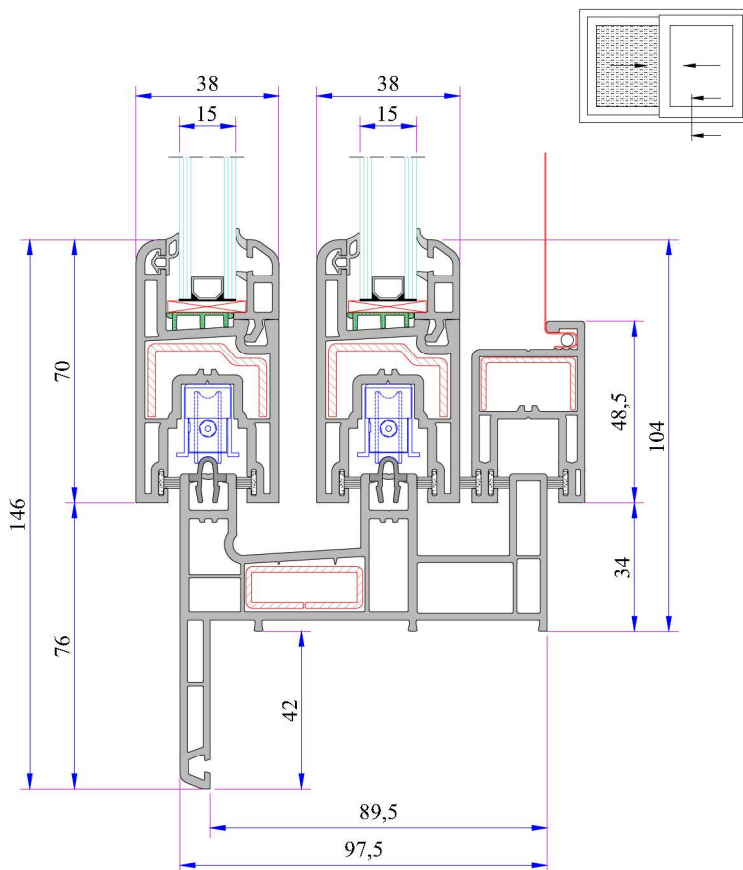

Double Rail Frame With Fly-Screen &
Sill - Sliding System Sash Installation

Double Rail Adaptor Profile Installation

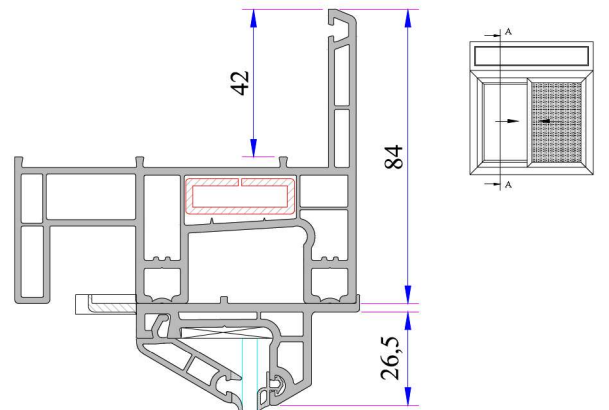

Section to be cut for
mullion profile

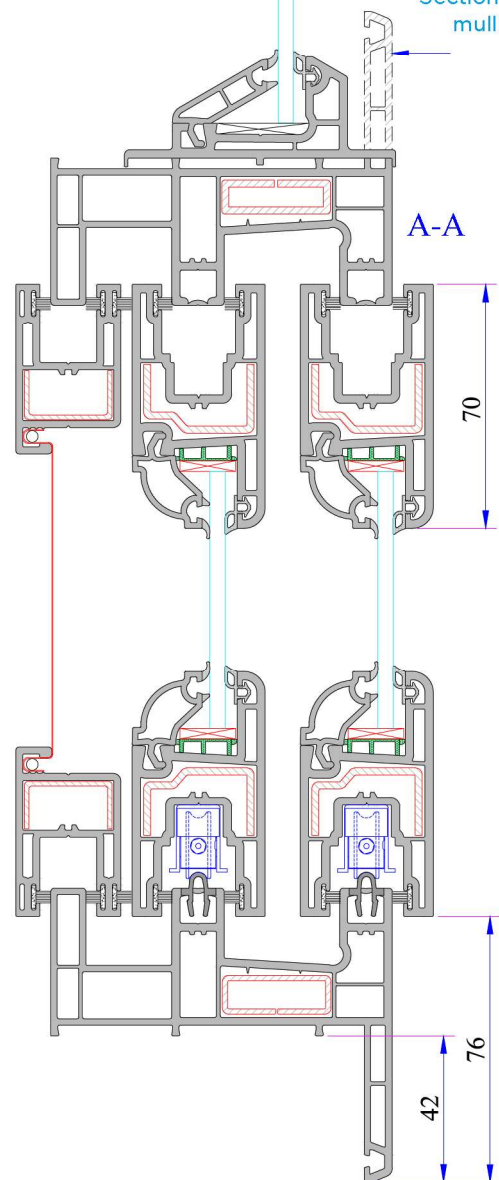

P 222 RAIL SERIES PVC PROFILE SYSTEM

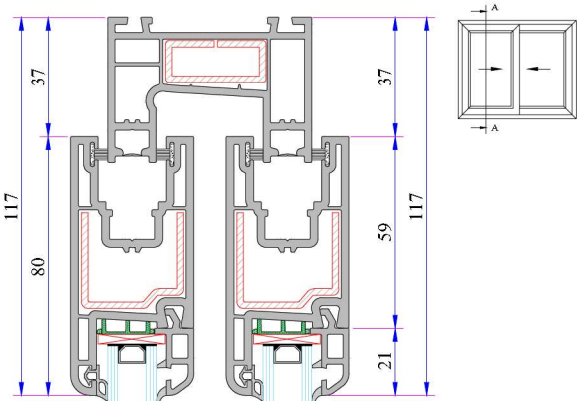

A-A

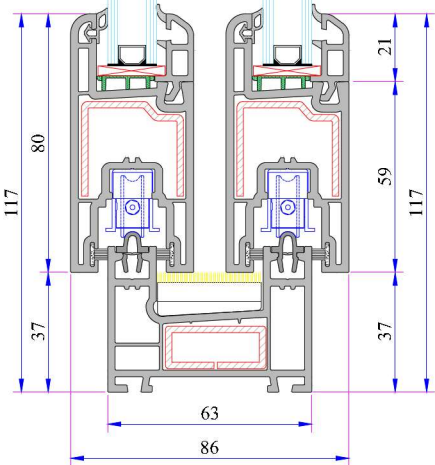

Double Railed Frame and Double Sash
Installation

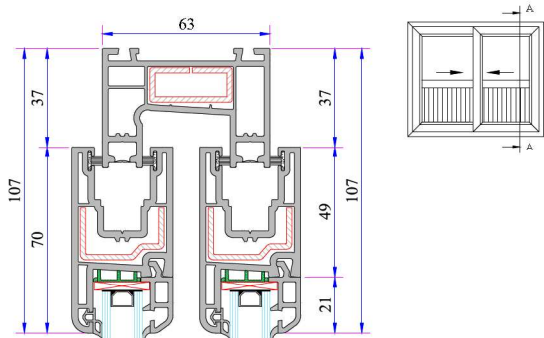

A-A

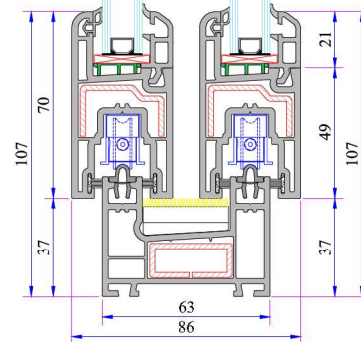
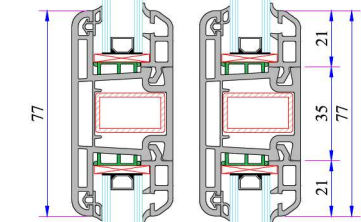

Mullion For Sash Installation

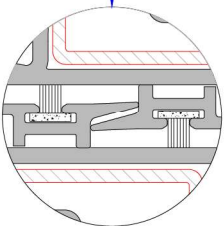
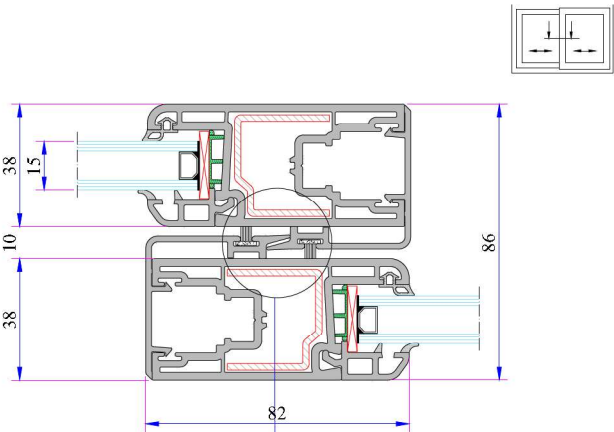

Sliding System Super Sash Back Cover
Profile Installation

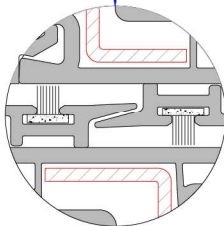
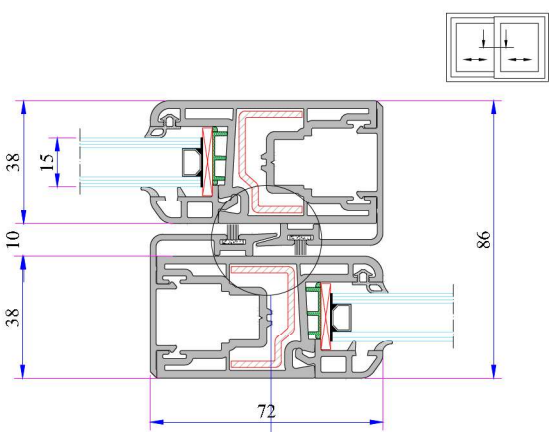

Sliding System Sash Back Cover Profile
Installation

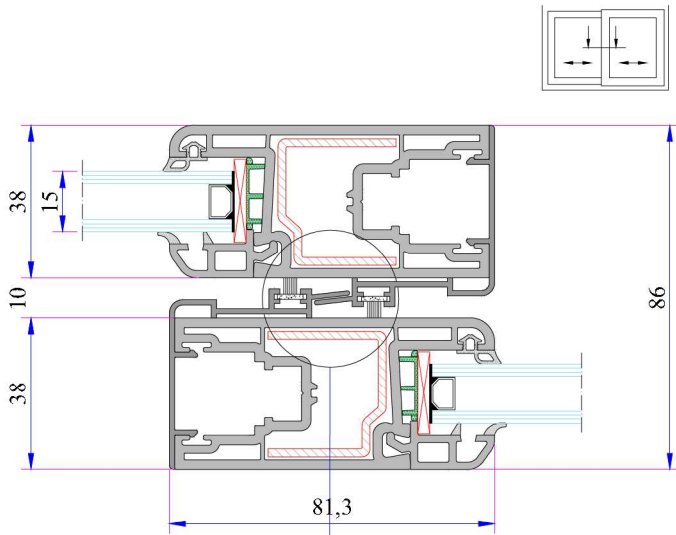

Sliding System Super Sash Alm. Back
Cover Profile Installation

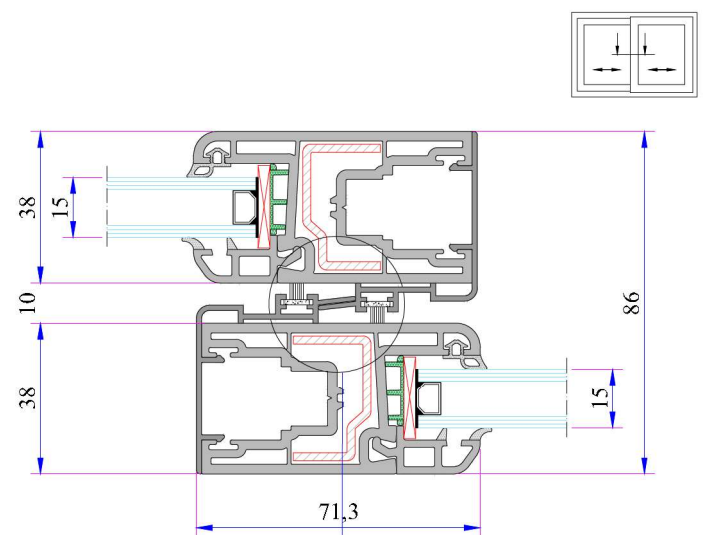

Sliding System Sash Alm. Back Cover
Profile Installation

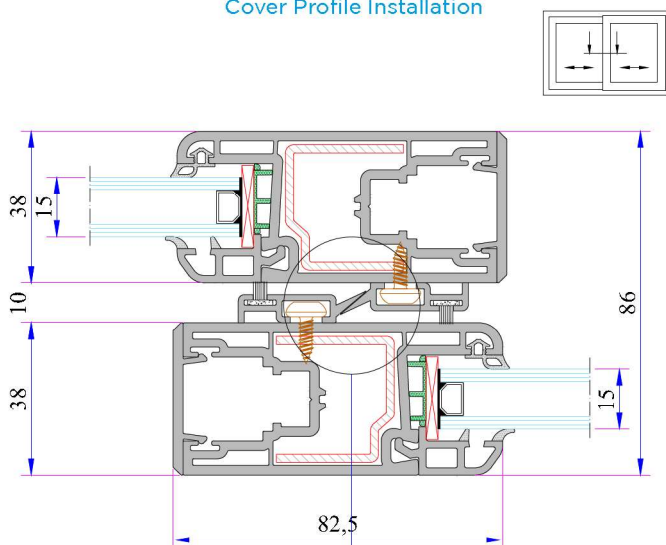

Sliding System Super Sash Lap Strip
Profile Installation

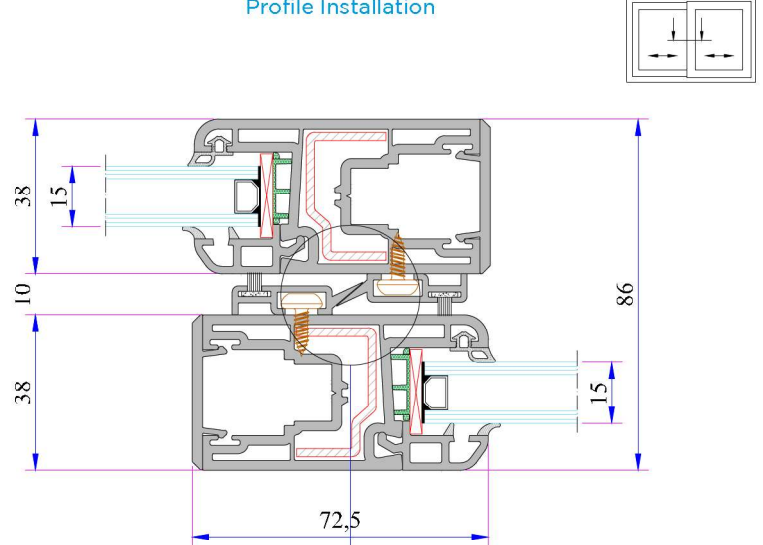

Sliding System Sash Lap Strip Profile
Installation

Sliding System Super Sash - Sash
 Cover Grillage Profile Installation

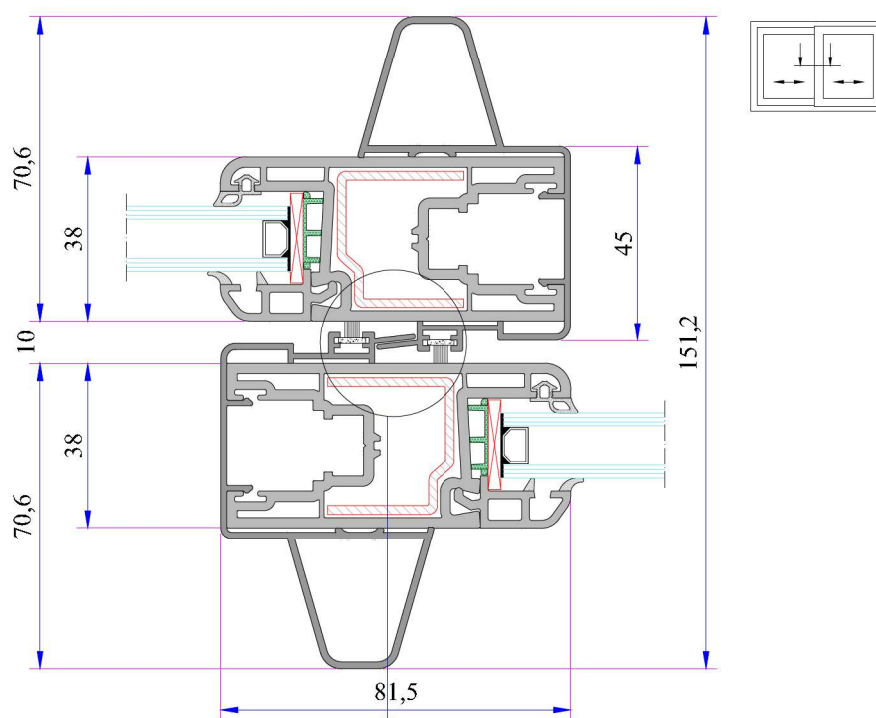

Alm. Double Sash Adaptor Profile
 Installation

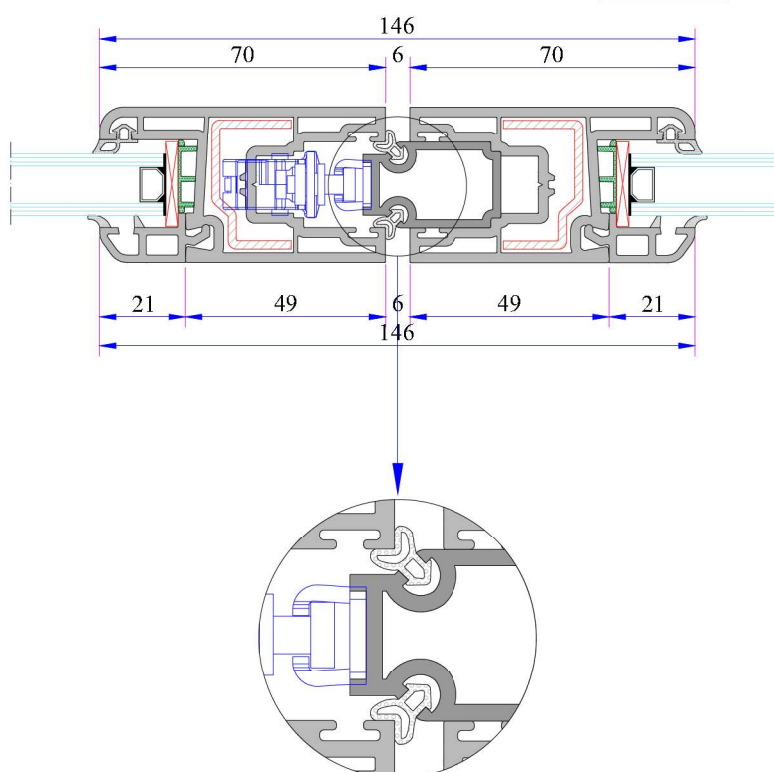



FACTORY

Antalya Organize Sanayi Bölgesi 2.Kısım Mah. 21.Cadde No:3

07040 Döşemealtı / ANTALYA / TURKEY

Tel : +90 242 236 20 00 · Faks : +90 242 236 20 90 · Email : info@ado.com.tr

