



PLASPEN[®]

**W ROLLER SHUTTER SERIES
SHUTTER SERIES**



INSTRUCTION

ADO ROLLER SHUTTER PROFILE SERIES

- With 190 x 190 mm, 190 x 225 mm, 225 x 225 mm, 155 x 155 mm, 4 different type of boxes give us possibility to work on desired wall thickness, width and height due to 190 x 225 mm ve 225 x 225 mm boxes, it has a chance to use roller shutter with heat insulation.
- It provides the possibility of installation inside and outside the wall. The installation of blade and maintenance - is possible from inside for all kinds room of renovation.
- It can be applied with motor, remote control and manual cord.
- The sliding rails are available with blade of roller shutter of measurements 37 mm, 39 mm, 42 mm, 50 mm, 55 mm.

LAMINATED COLORS



**GOLDEN OAK
ST 500**



**DARK OAK
ST 501**



**SWAMP OAK
ST 503**



**LIGHT OAK
ST 515**



**GREY SAND
AS 509**



**GREY
ST 507**



**ANT. GREY
ST 508**



**ANT. GREY
AS 508**



**MAHOGANY
ST 504**



**CREAM
AS 057**

ROLLER SHUTTER PROFILE SYSTEM

190x190mm BOX OF RULLER SHUTTER

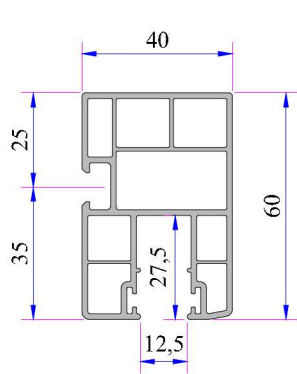

37 mm Blade Side Rail

Code:

P.A.037.5602.600.0.00.19

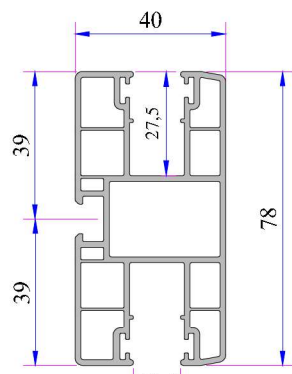

37 mm Blade For Center Rail

Code:

P.A.037.5603.600.0.00.19



190x190 mm Box (Ext Insd Up) Profile

Code: P.A.097.5601.600.0.00.19

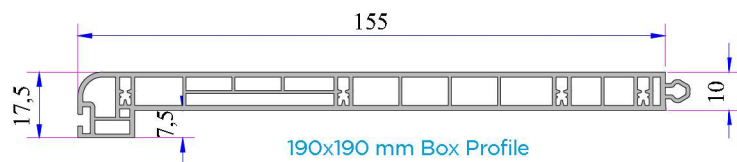

190x190 mm Box Profile

Code: P.A.097.5600.600.0.00.19

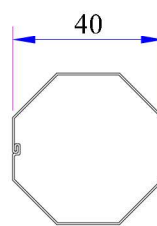

**Shutter Rewinding Drum
Galvanized**

Code: 34019-41040

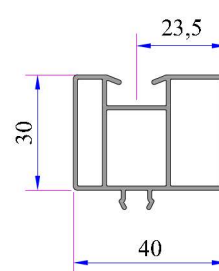

**Shutter Side Rail
Lifting Profile**

Code: 21108-01000

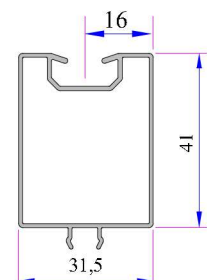

**Shutter Side Rail
Lifting Profile**

Code: AD16-050

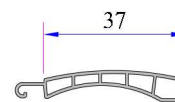

37mm Shutter Blade

Code: P.PNJ.01.37.IH.1.6000

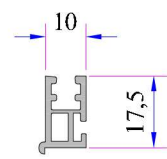

PVC Bumber Bead

Code: P.A.097.5605.600

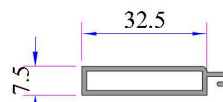

**Alm. Shutter Blade For
Weight**

Code: 16012.601.5.1.1.9016

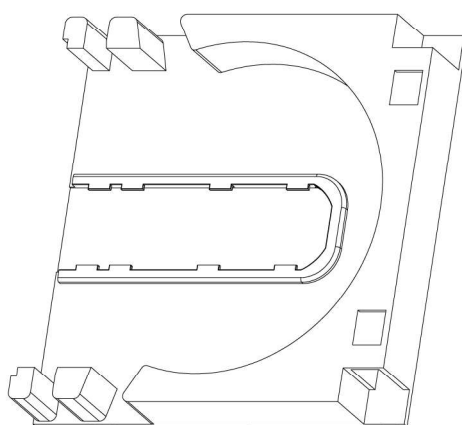

190x190 mm Shutter Side Cover

Code: 34019-11240

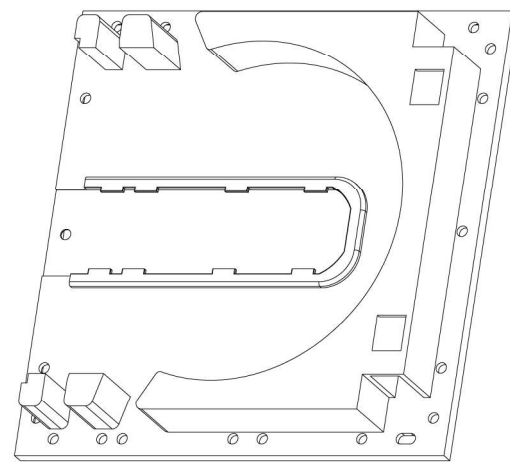

190x190 mm Shutter Middle Cover

Code: 34019-11210

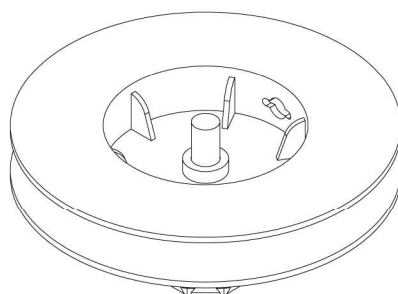

Big Roller

Code: 34019-11280

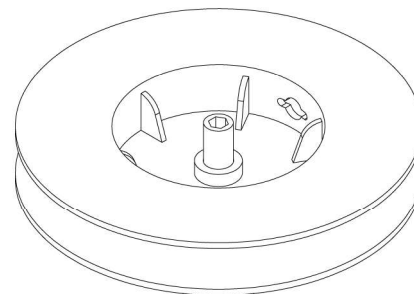

Big Roller (Controlled By Unique Control Point)

Code: 34019-11420

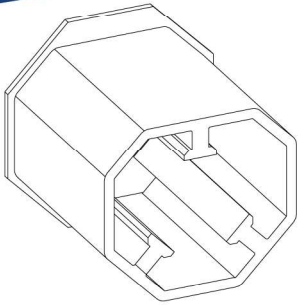

Shutter 40x60 Muff
Code: 34019-11300

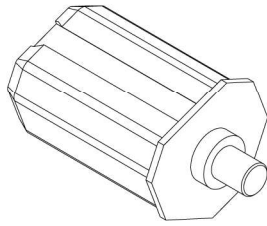

Shutter Small Roller
Code: 34019-11290

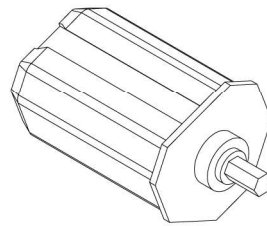

Small Roller Controlled By Unique
Control Point)
Code: 34019-11410

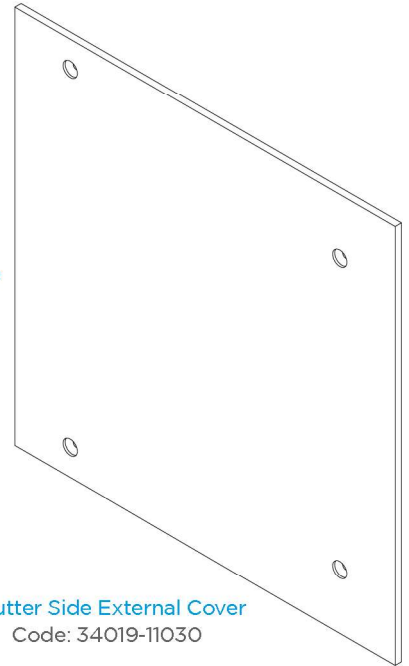

Shutter Side External Cover
Code: 34019-11030

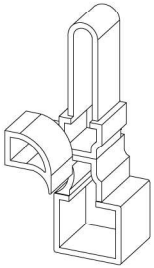

Shutter Rail On Side
Code: 34019-11110

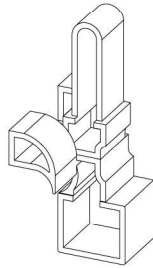

Shutter Rail In The Middle
Code: 34019-11310

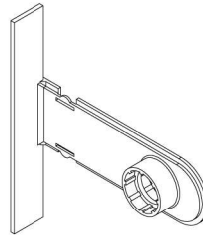

Shutter Side and Middle Roller
Code: 34019-11250

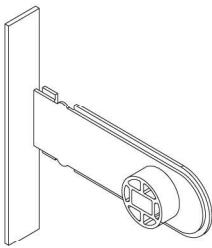

Shutter Side and Middle Roller (It Is
For Motorized Roller Shutter)
Code: 34019-11260

- 1- Box External - Superior - Inner profile
- 2- Bottom box profile
- 3- Big roller
- 4- Side cover sled
- 5- Side cover
- 6- New side rail
- 7- Rails beading sled (Right - Left)
- 8- PVC Bumber bead
- 9- Shutter blade
- 10- Alm. Blade for the weight
- 11- Middle fly screen with pile profile

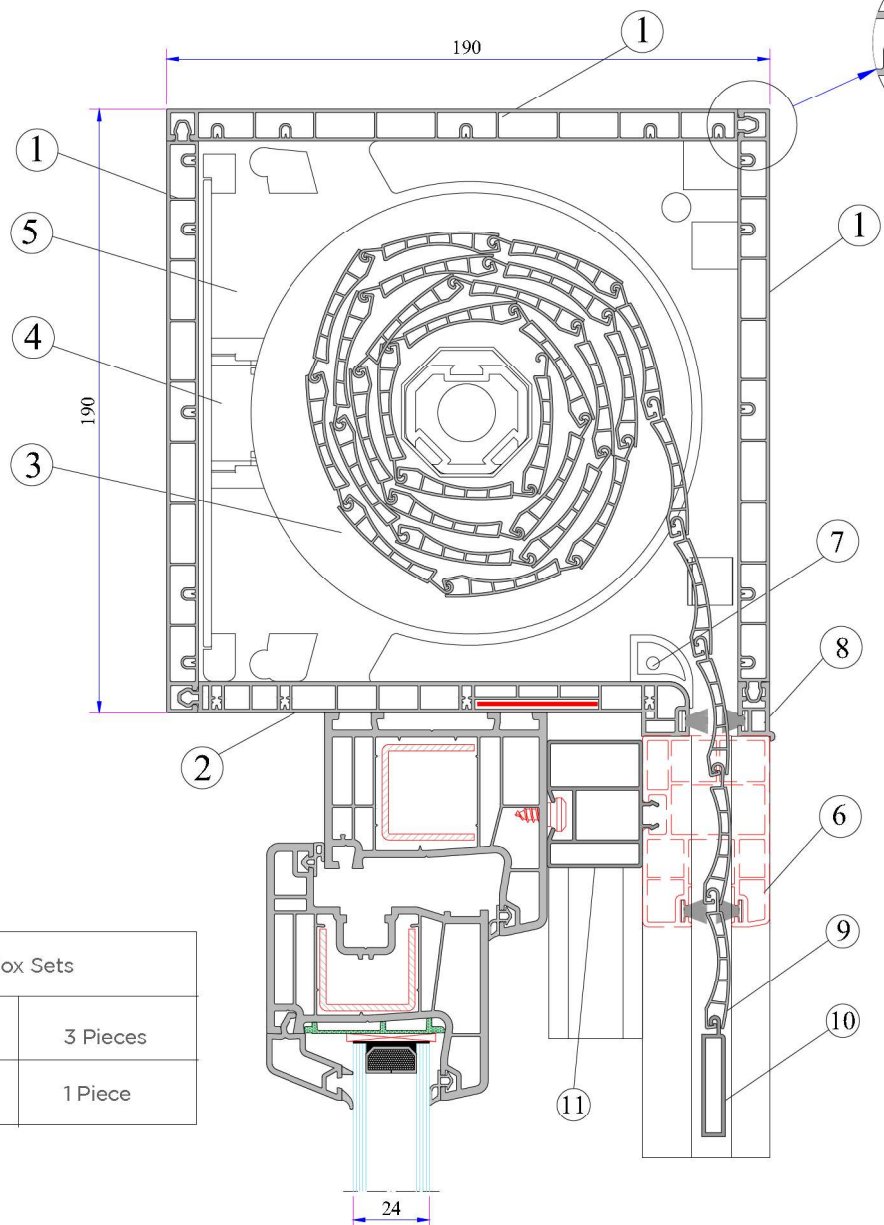

190 x 190 mm Roller Shutter Box Sets	
Roller Shutter, Inner External and Superior Box Profile	3 Pieces
Roller Shutter Lower Box Profile	1 Piece

ROLLER SHUTTER PROFILE SYSTEM

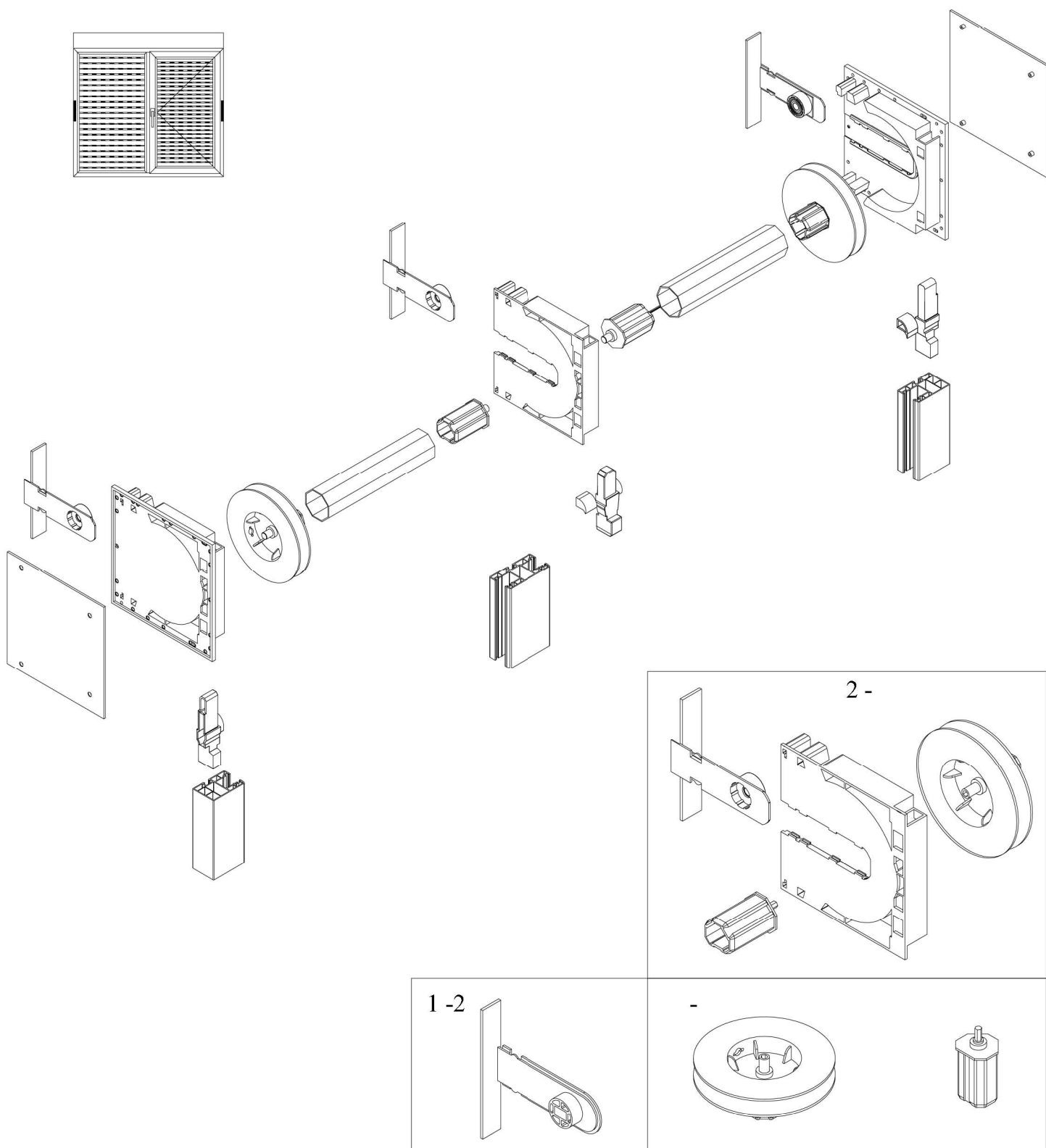

Notes:

1. In case of motorized roller shutter use, only the inner side of the roller bearing should be selected as rectangular. The picture is upwards section.
2. The single-point controlled (which does not matter whether it is corded or motorized) roller shutters including 2-3-4 pieces will have the option of transferring the small and large roller at each crossing point. The small and large rollers pass each other with hexagonal heads.

190x225mm INSULATED ROLLER SHUTTER BOXES

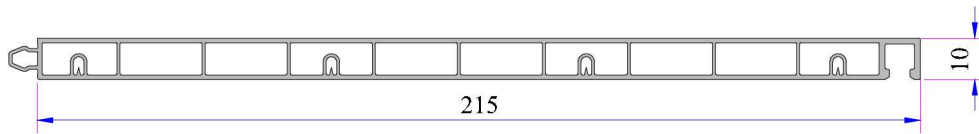

190x225 Insulated Above Side Box Profile
Code: P.A.097.5611.600.0.00.19

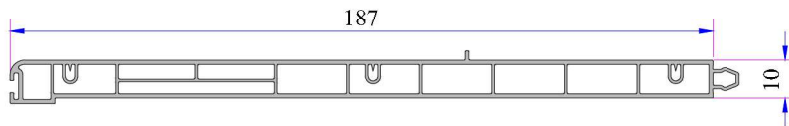

190x225 Insulated Bottom Side Box Profile
Code: P.A.5612.600.0.00.19

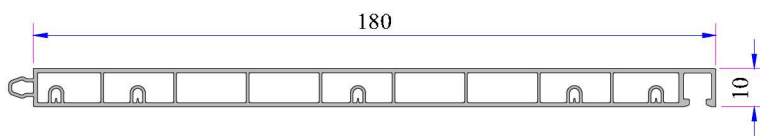

190x225 Insulated External And Inner Box Profile
Code: P.A.097.5601.600.0.00.19

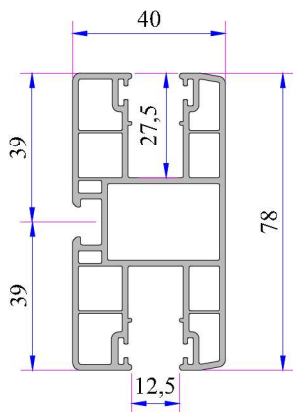

37' Side Rail Blade
Code: P.A.097.5603.600.0.00.19

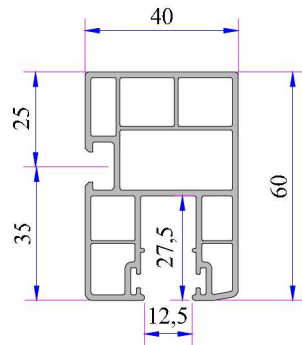

37' Middle Rail Blade
Code: P.A.097.5602.600.0.00.19

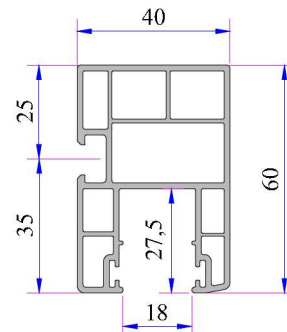

55' Side Rail Blade
Code: P.A.097.5613.600.0.00.19

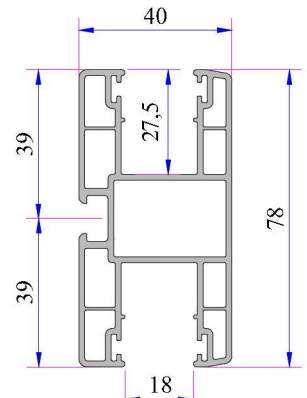

55' Middle Rail Blade
Code: P.A.097.5614.600.0.00.19

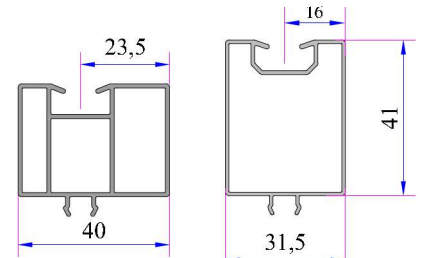

Shutter Side Rail Lifting Profile
Code: 21108-01000

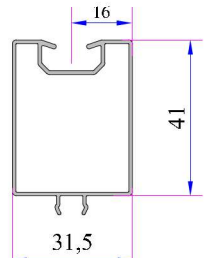

Shutter Side Rail Lifting Profile
Code: AD16-050

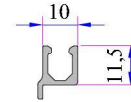

Alm. Bumber Bead
Code: 16036.601.5.1.1.9016

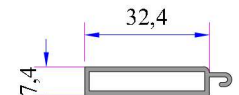

Alm. Blade For Weight
Code: 16012.601.5.1.1.9016

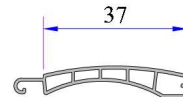

37' Shutter Blade
Code: P.PNJ.01.37.IH.1.6000

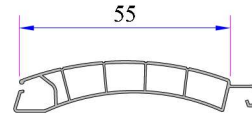

55' Shutter Blade
Code: P.PNJ.01.55.1.6000

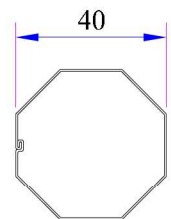

Shutter Rewinding Drum Galvanized
Code: 34019-41040

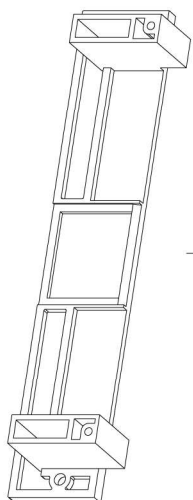

190x225 mm Insulated Roller Shutter Side Extension Cover
Code: 34019-11020

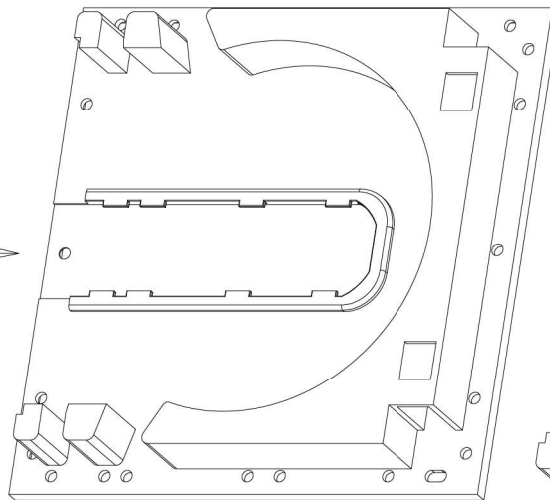

190x190 mm Shutter Side Cover
Code: 34019-11210

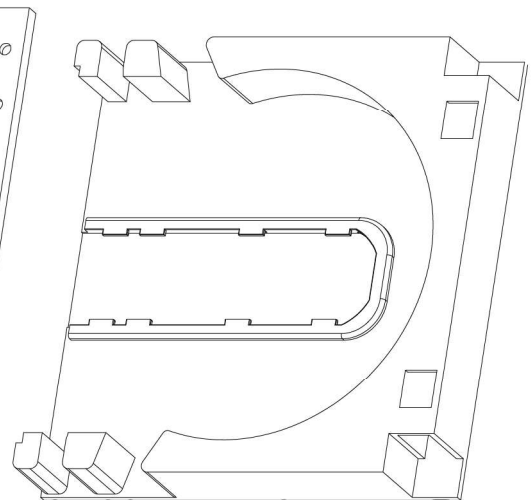

190x190 mm Shutter Middle Cover
Code: 34019-11240

ROLLER SHUTTER PROFILE SYSTEM

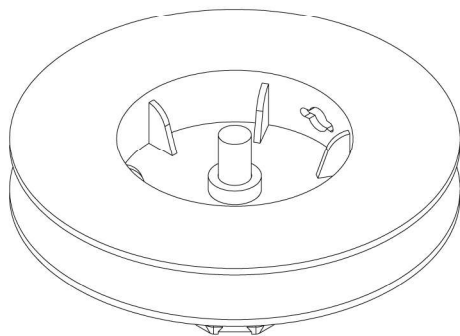

Shutter Big Roller
Code: 34019-11280

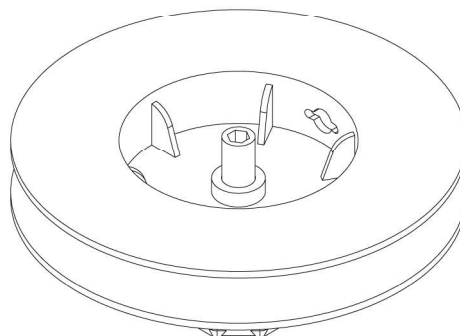

Big Roller (Controlled by Unique Control Point)
Code: 34019-11420

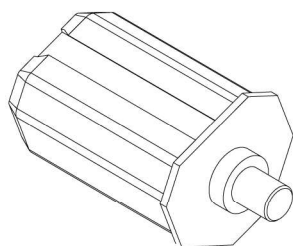

Shutter Small Roller
Code: 34019-11290

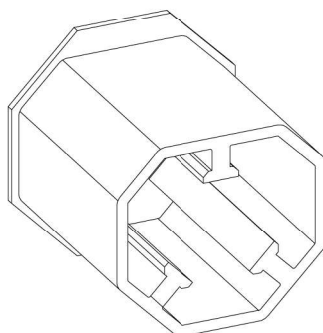

Shutter 40x60 Muff
Code: 34019-11300

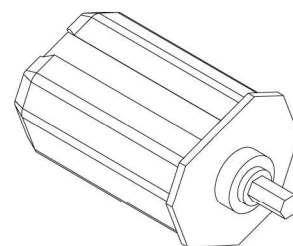

Small Roller (Controlled By
Unique Control Point)
Code: 34019-11410

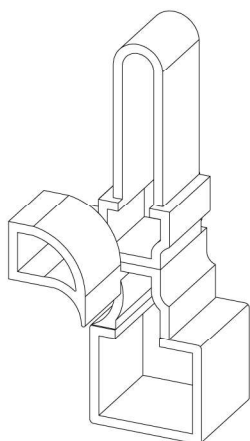

Shutter Side Rail Sled
Code: 34019-11110

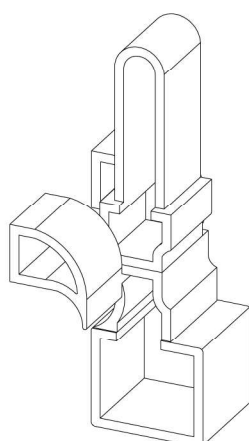

Shutter Middle Rail Sled
Code: 34019-11310

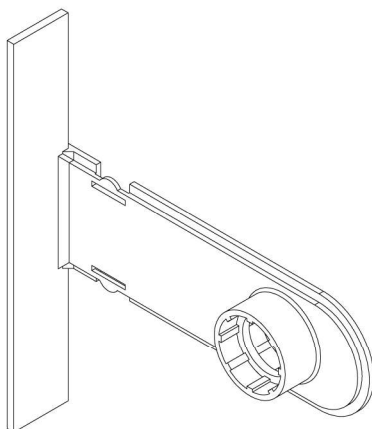

Shutter Side and Middle
Roller Setting
Code: 34019-11250

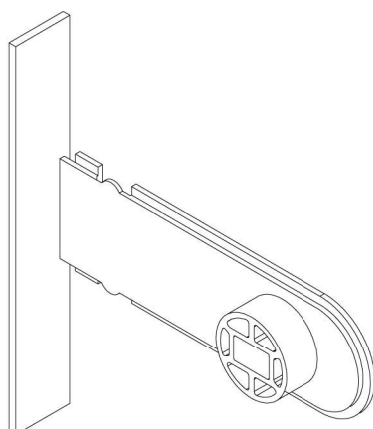

Shutter Side and Middle Roller Setting
(for Motorized Shutters)
Code: 34019-11260

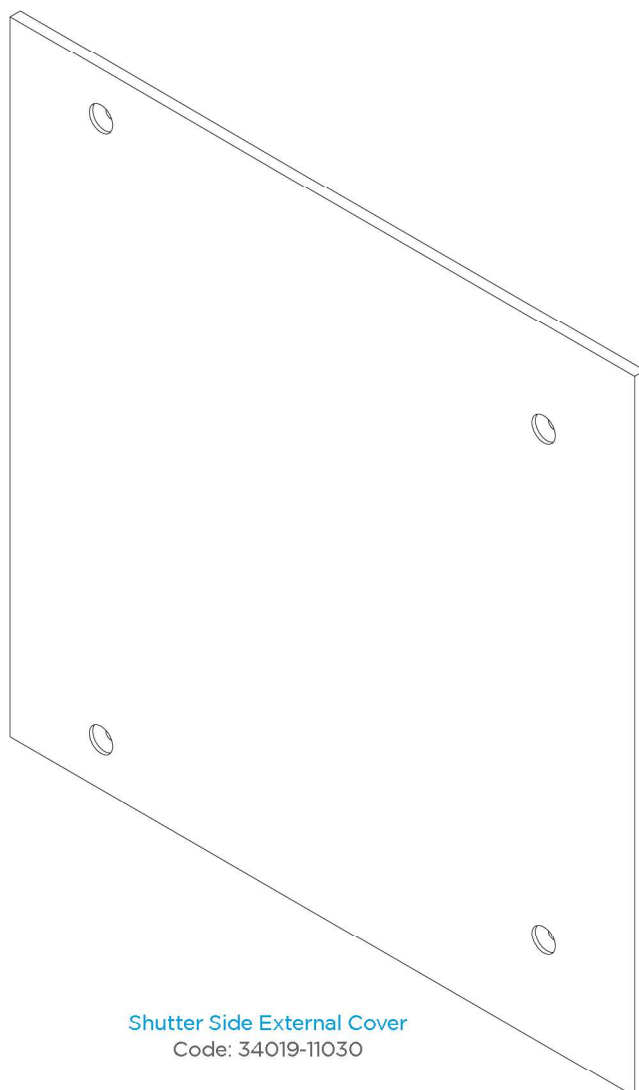

Shutter Side External Cover
Code: 34019-11030

- 1- 225' Shutter Box Profile
- 2- 190' Shutter Box Profile
- 3- 225' Shutter Bottom Box Profile
- 4- 37 - 55 Shutter Side Rail Profile
- 5- Alm. Bumber Bead
- 6- Shutter Insulation Material

190X225mm Shutter Box Profile	
225x225mm Shutter Superior Box Profile	1 Piece
190x190mm Shutter External and Inner Profile	2 Pieces
225x225mm Shutter Bottom Box Profile	1 Piece

- 1- For 2400mm height, 37mm total 66 pieces lamel + alm. Screw will be used. (H/37mm + 1 Piece)
- 2- Total quantity of lamels is 27 in 1m 27. (1000/37mm)

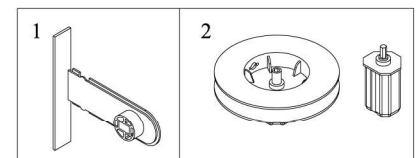
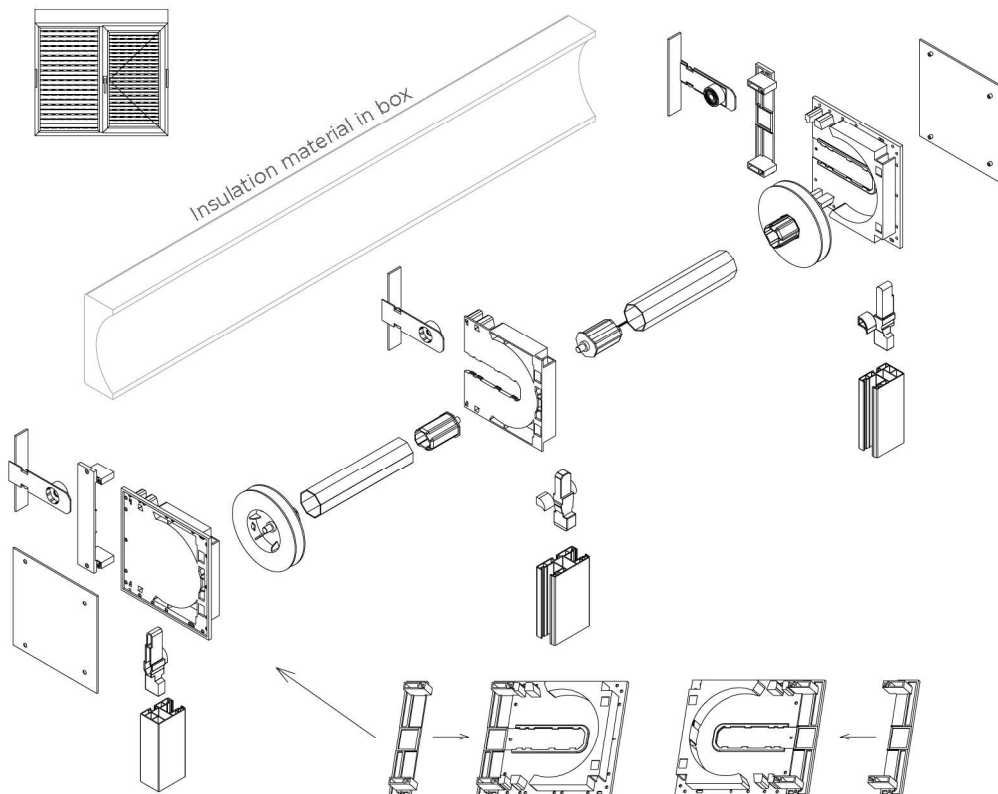
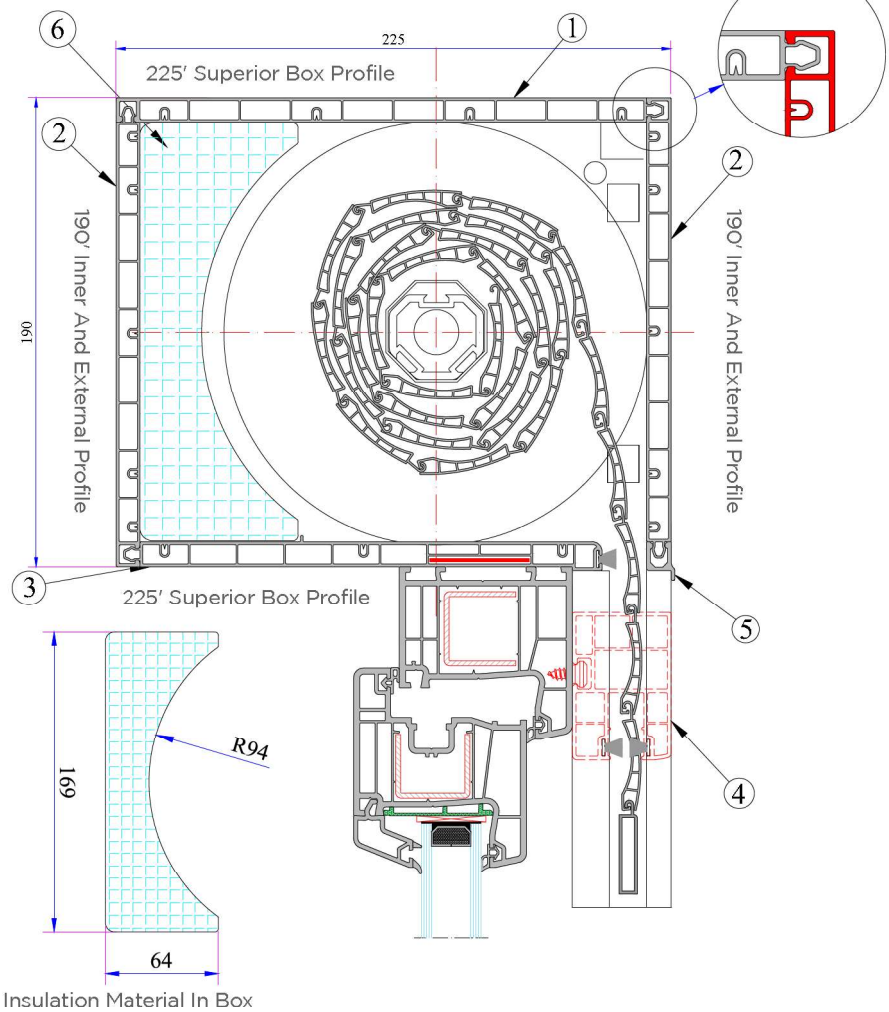

The normal 190 x 190mm shutter is becoming a 190 x 225mm shutter box cover insulated with an additional extension cover on the inner side cover.

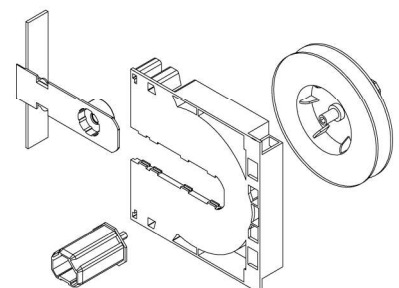

Optional Pieces For Single Head Control

Note:

- 1- In case of motorized roller shutter use, only the inner side of the roller bearing should be selected as rectangular. The picture is upwards section.
- 2- The single-point controlled (which does not matter whether it is corded or motorized) roller shutters including 2-3-4 pieces will have the option of transferring the small and large roller at each crossing point. The small and large rollers pass each other with hexagonal heads.

ROLLER SHUTTER PROFILE SYSTEM

225x225mm SHUTTER BOXES

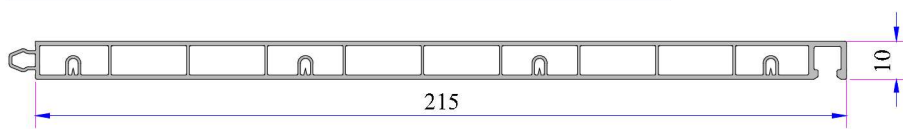

225x225' Insulated Superior Box Profile
Code: P.A.097.5611.600.0.00.19

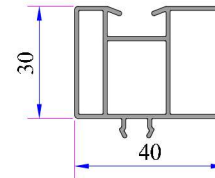

Shutter Side Rail Lifting Profile
Code: 21108-01000

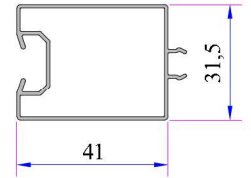

Shutter Side Rail Lifting Profile
Code: AD16-050

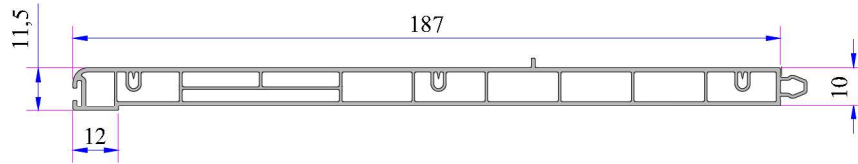

225x225' Insulated Bottom Profile
Code: P.A.097.5612.600.0.00.19

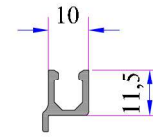

Alm. Bumber Bead
Code: 16036.601.5.11.9016

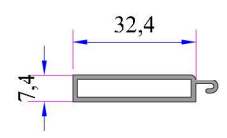

37' Blade Alm. For Weight
Code: 16012.601.5.11.9016

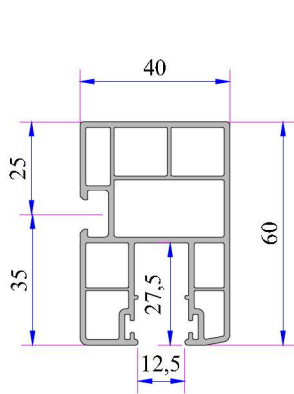

37' Side Blade
Code: P.A.097.5602.600.0.00.19

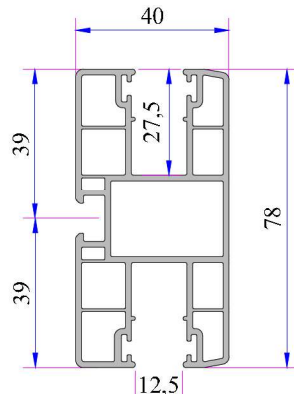

37' Middle Rail Blade
Code: P.A.097.5603.600.0.00.19

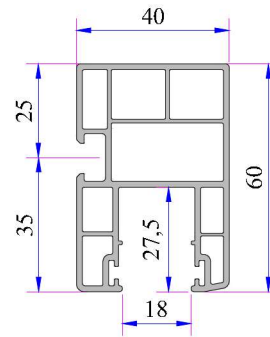

55' Side Rail Blade
Code: P.A.097.5613.600.0.00.19

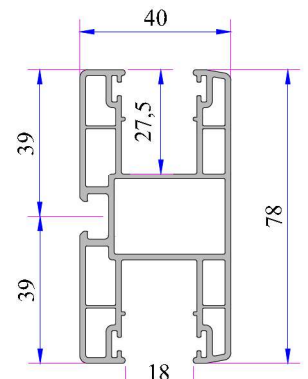

55' Middle Rail Blade
Code: P.A.097.5614.600.0.00.19

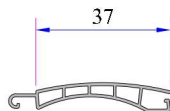

37' Shutter Blade
Code: P.PNJ.01.37.IH.1.6000

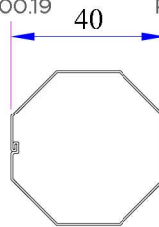

Shutter Rewinding Drum Profile Galvanized
Code: 34019-41040

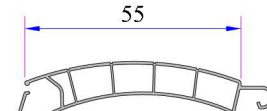

55' Shutter Blade
Code: P.PNJ.01.55.1.6000

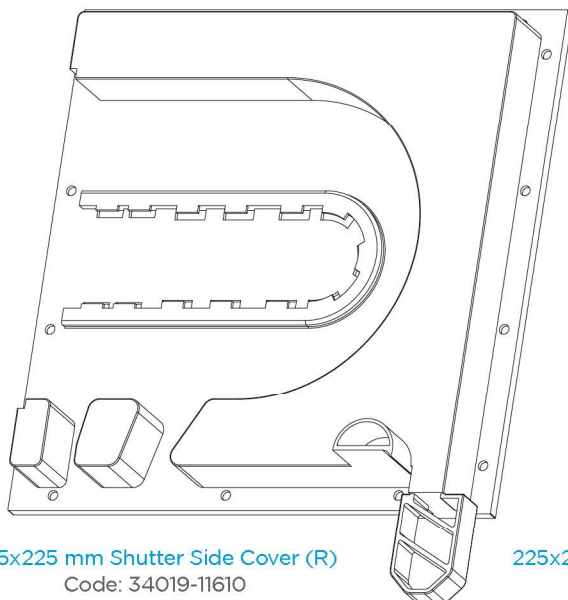

225x225 mm Shutter Side Cover (R)
Code: 34019-11610

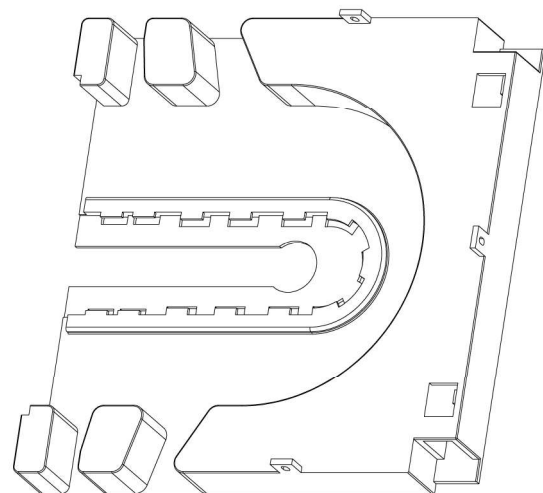

225x225 mm Shutter Middle Cover
Code: 34019-11710

225x225 mm Shutter Side Cover (L)
Code: 34019-11620

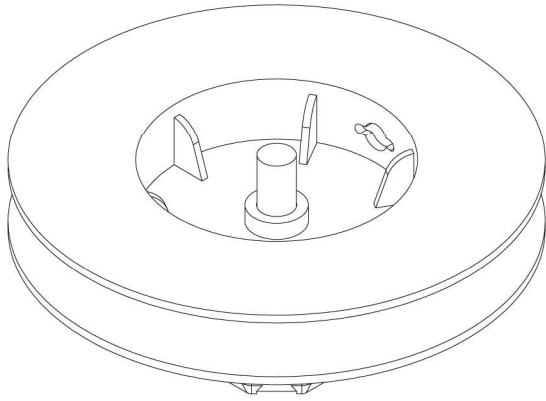

Shutter Big Roller
Code: 34019-11280

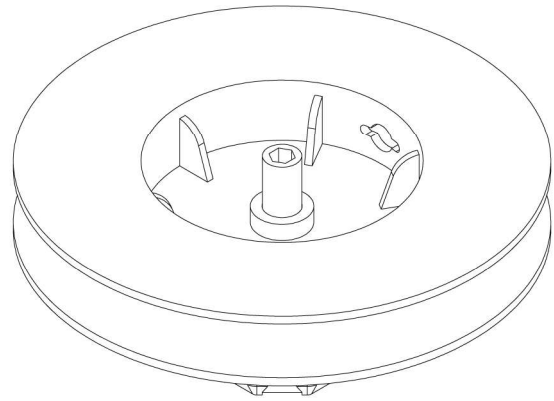

Big Roller (It Is Controlled By Unique Point)
Code: 34019-11420

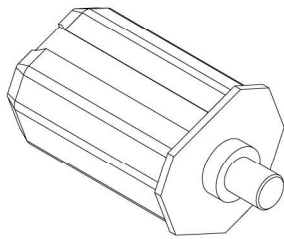

Shutter Small Roller
Code: 34019-11290

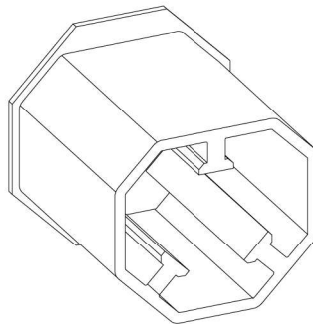

Shutter 40x60 Muff
Code: 34019-11300

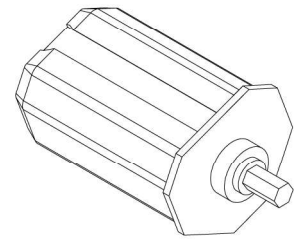

Small Roller (It is Controlled By Unique Point)
Code: 34019-11410

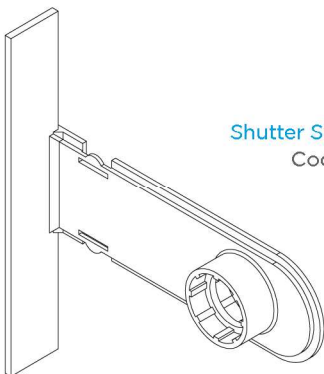

Shutter Side And Middle Roller
Code: 34019-11250

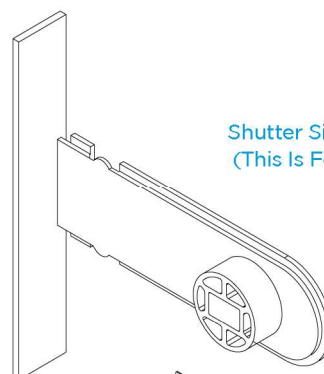

Shutter Side And Middle Roller Sitting
(This Is For Motorized Roller Shutter)
Code: 34019-11260

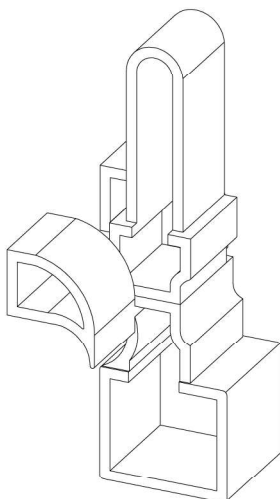

Shutter Middle Rail Sled
Code: 34019-11310

Shutter External Side Cover
Code: 34019-11510

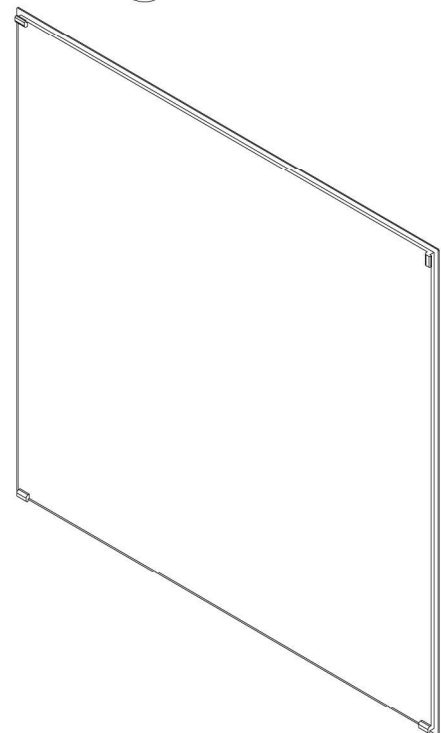

ROLLER SHUTTER PROFILE SYSTEM

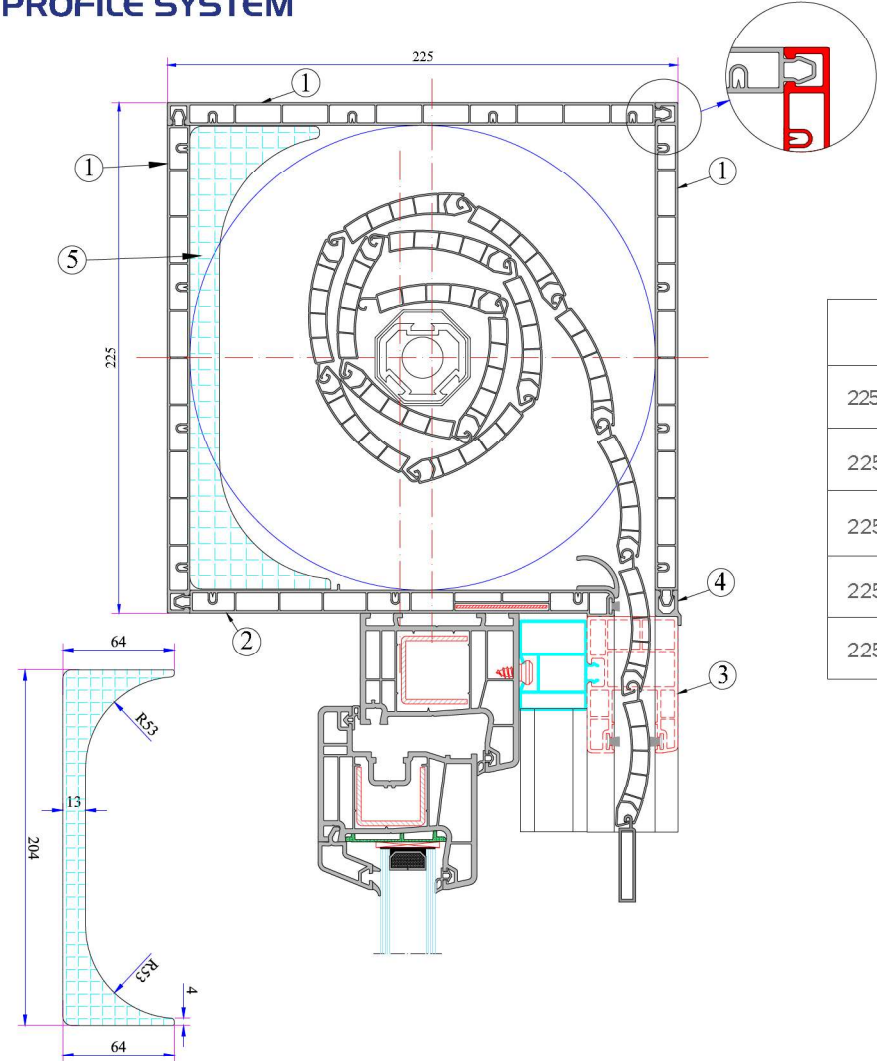

Insulation Material For Boxes

225x225mm Shutter Box Set	
225x225mm Shutter Inner And External Box Profile	3 Pieces
225x225mm Shutter Lower Side Box Profile	1 Piece
225x225mm Shutter Side Rail Profile	2 Pieces
225x225mm Alm. Bumber Bead	1 Piece
225x225mm Insulation Materials For Boxes	1 Piece

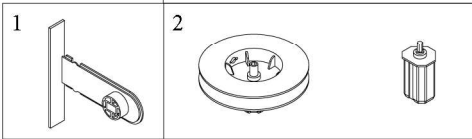
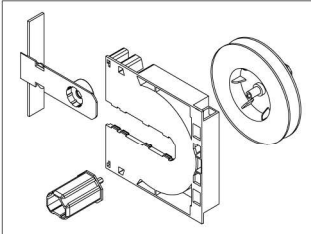

Optional Pieces For Single Hand Control

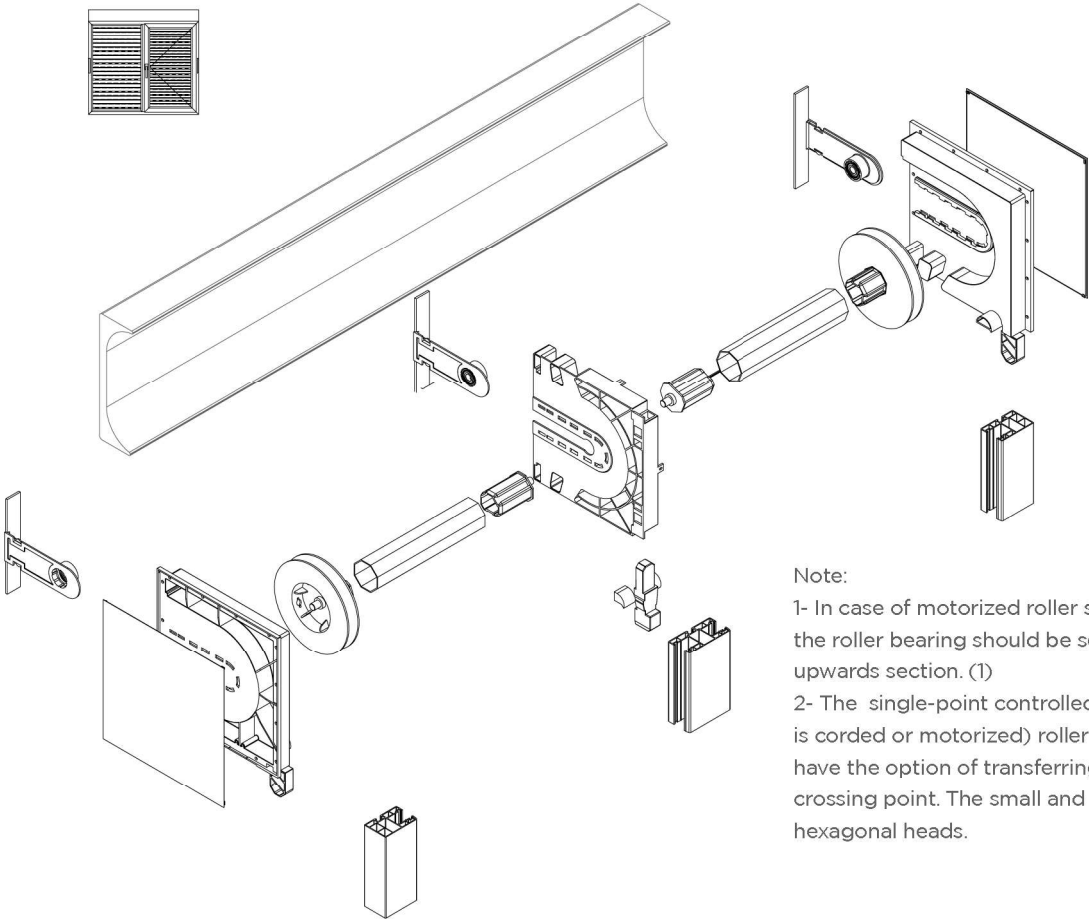

Note:

1- In case of motorized roller shutter use, only the inner side of the roller bearing should be selected as rectangular. The picture is upwards section. (1)

2- The single-point controlled (which does not matter whether it is corded or motorized) roller shutters including 2-3-4 pieces will have the option of transferring the small and large roller at each crossing point. The small and large rollers pass each other with hexagonal heads.

155x155mm SHUTTER BOXES

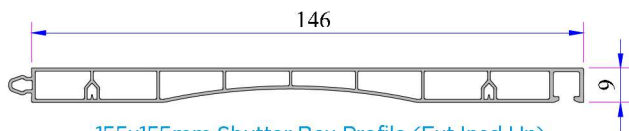

155x155mm Shutter Box Profile (Ext Insd Up)
Code: P.A.097.5607.600.0.00.19

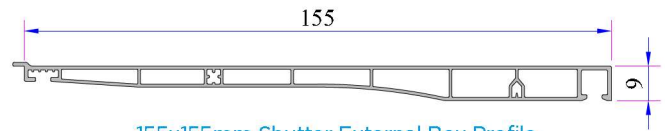

155x155mm Shutter External Box Profile
Code: P.A.097.5606.600.0.00.19

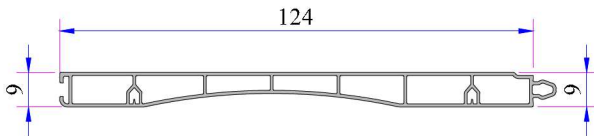

155x155mm Shutter Bottom Box Profile
Code: P.A.097.5608.600.0.00.19

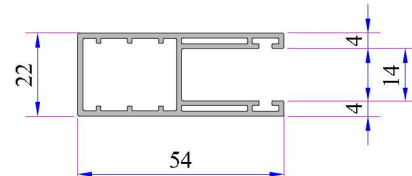

155x155mm Shutter Side Rail Profile
Code: P.A.097.5609.600.0.00.19

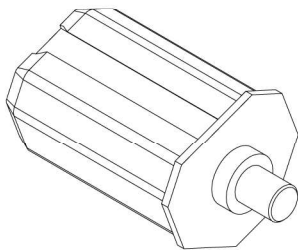

Shutter Small Roller
Code: 34019-11290

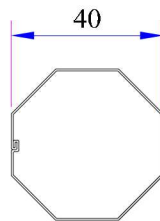

Shutter Rewinding Drum Galvanized
Code: 34019-41040

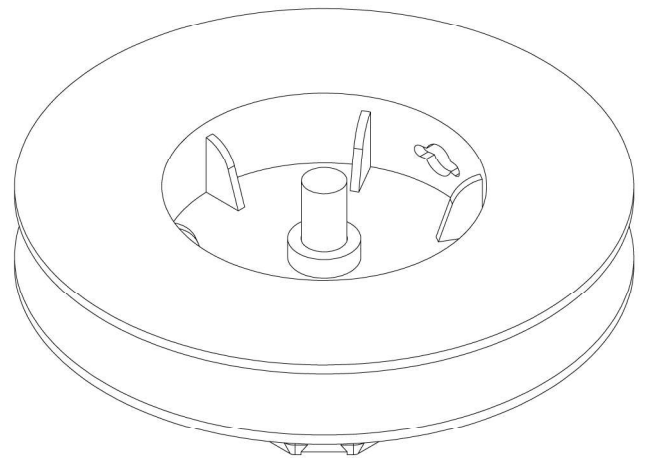

Shutter Big Roller
Code: 34019-11280

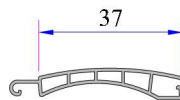

37' Shutter Blade
Code: P.PNJ.01.37.IH.1.6000
(White)

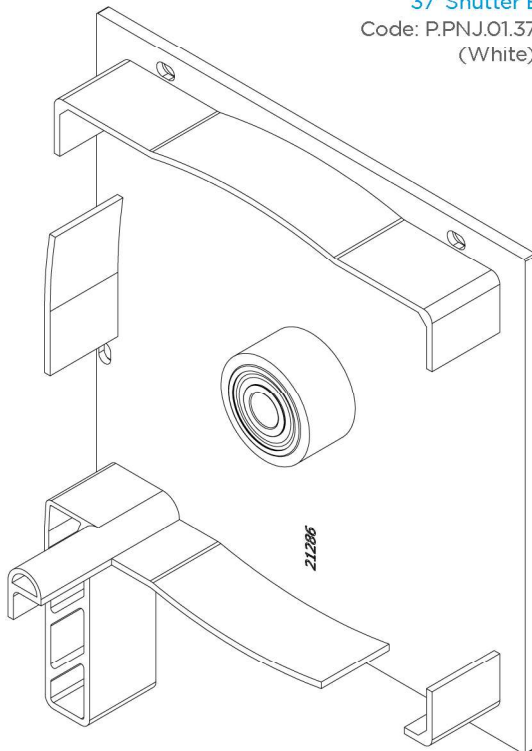

155x155 mm Corded Shutter Side Profile Left And Right Are Different
Code: 34019-11040

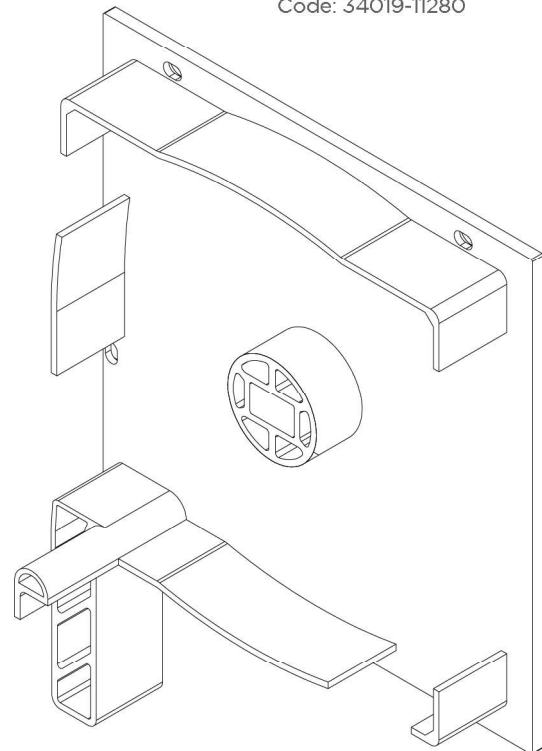

155x155 mm Motorized Shutter Side Cover (Left And Right Are Different)
Code: 34019-11050

ROLLER SHUTTER PROFILE SYSTEM

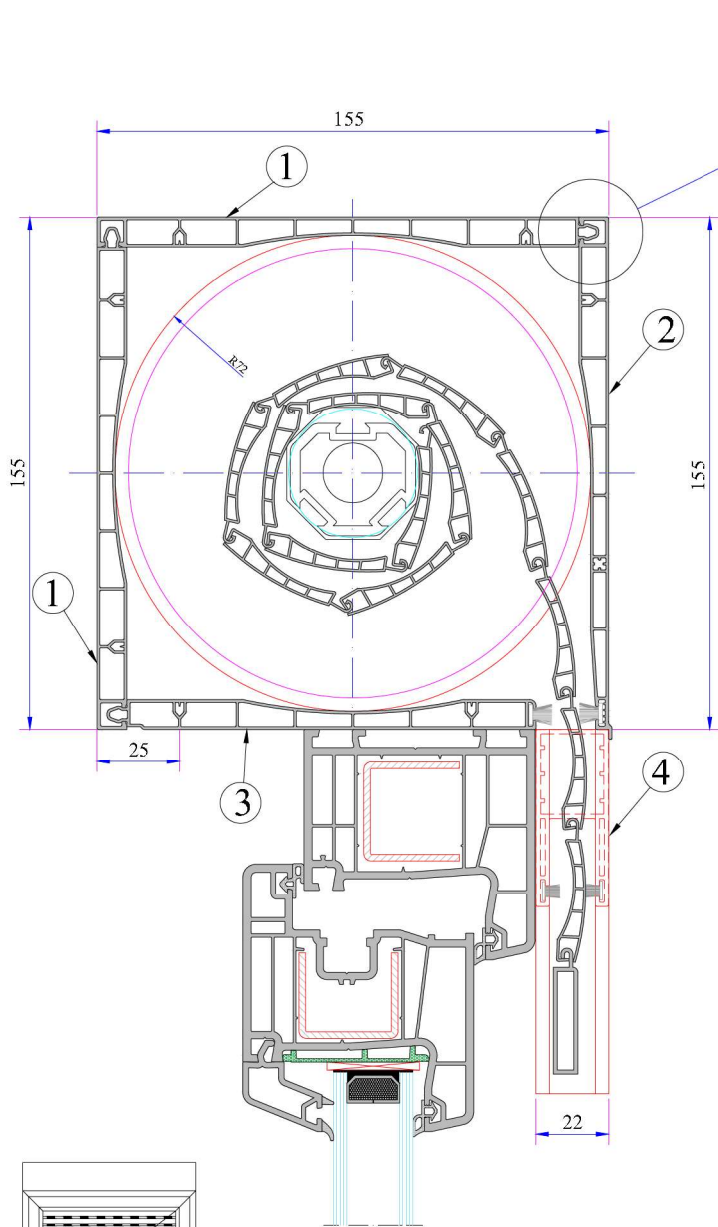

155x155mm Roller Shutter Box Systems		
1	Shutter Inner And Superior Box Profile	2 Pieces
2	Shutter External Box Profile	1 Piece
3	Shutter Lower Side Box Profile	1 Piece
4	Shutter Side Rail Profile	2 Pieces

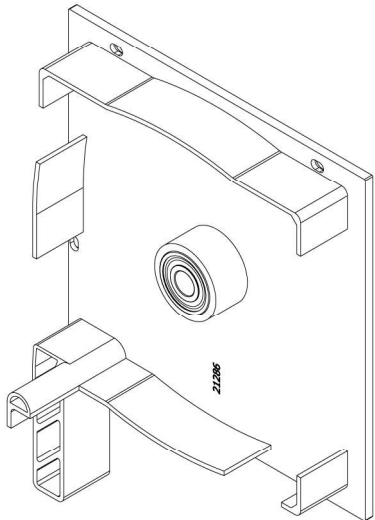

155x155 mm Corded Shutter Side Cover
(Right And Left Side Are Different)
Code: 34019-11040

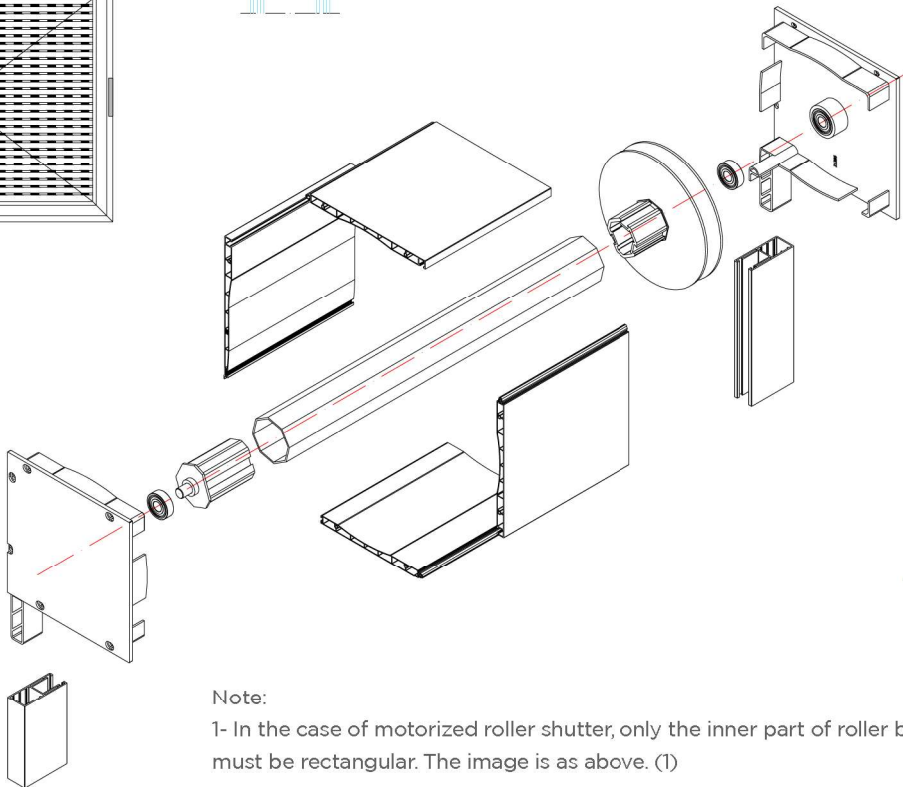
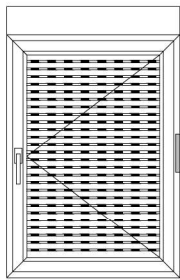

155x155 mm Motorized Shutter Side Cover
(Right And Left Sides Are The Same)
Code: 34019-11050

Note:
1- In the case of motorized roller shutter, only the inner part of roller bearing must be rectangular. The image is as above. (1)

SHUTTER MAIN PROFILES

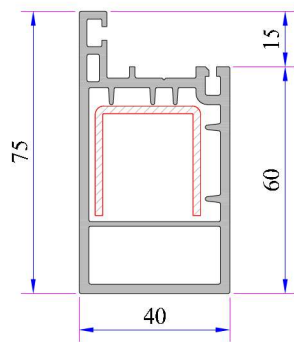

Sash Profile
Code:
P.A.098.5900.600.0.00.19

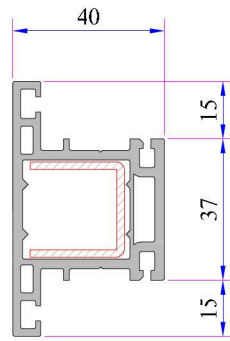

Mullion Profile
Code:
P.A.098.5901.600.0.00.19



SHUTTER AUXILIARY PROFILES

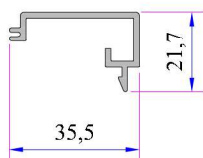

Sash Cover Profile
Code:
P.A.098.5905.600

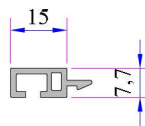

Shutter Blade Bead
Code:
P.A.098.5904.600

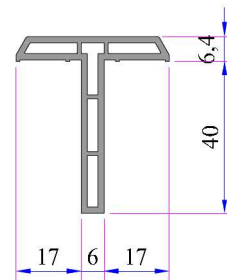

T Profile
Code: P.A.098.5902.600

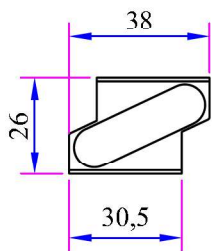

Single Sled
Code: 34020-11010

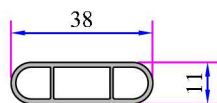

Shutter Blade
Code:
P.A.098.5603.600

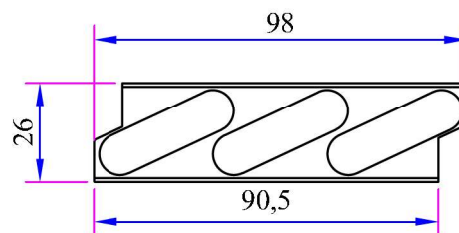

Shutter Blade Bead
Code: 34020-11020



SHUTTER INSTALLATION

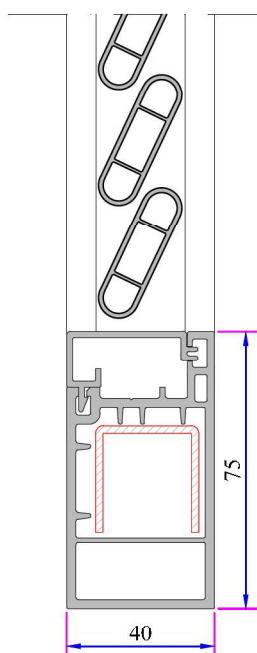

Shutter Blade Sash Installation

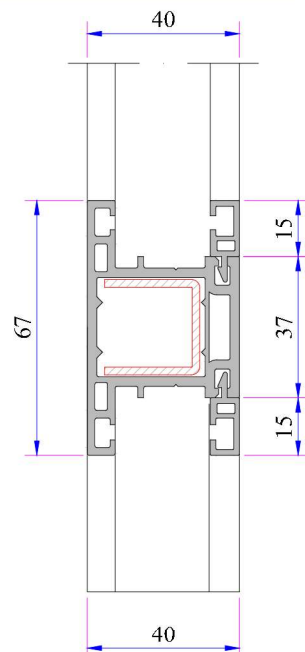

Shutter Mullion Installation

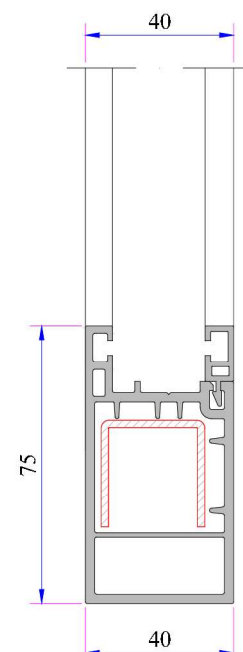

Shutter Blade Bead Installation

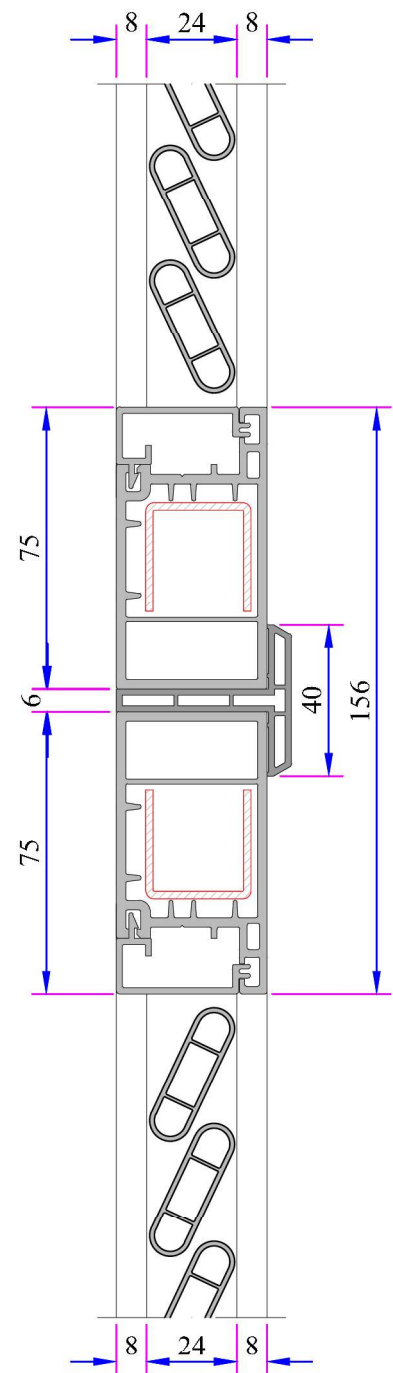

Shutter Installation

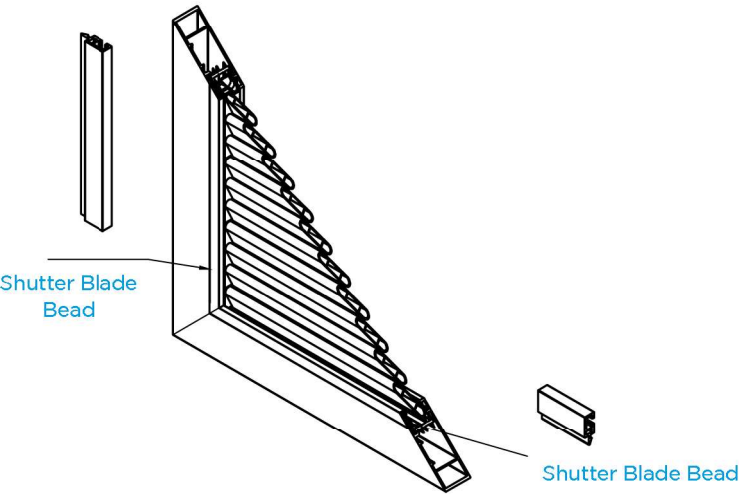
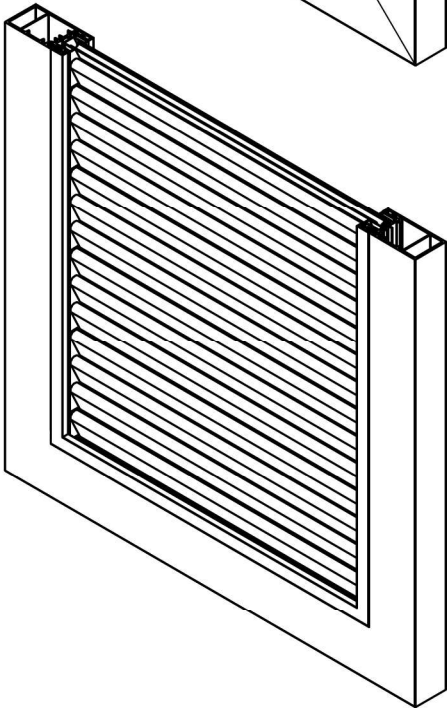
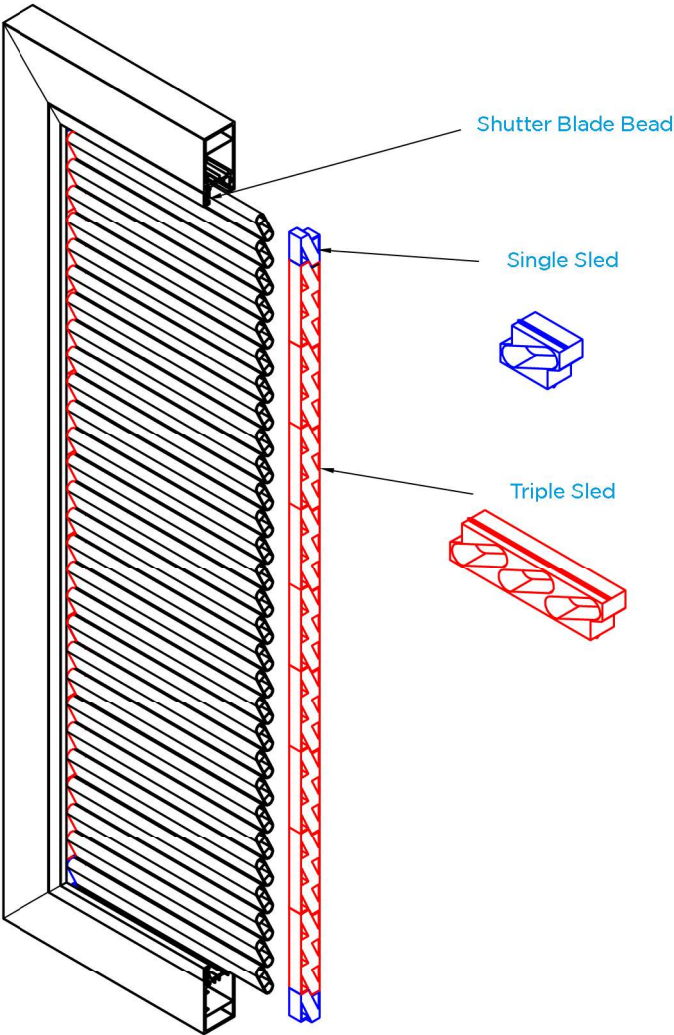
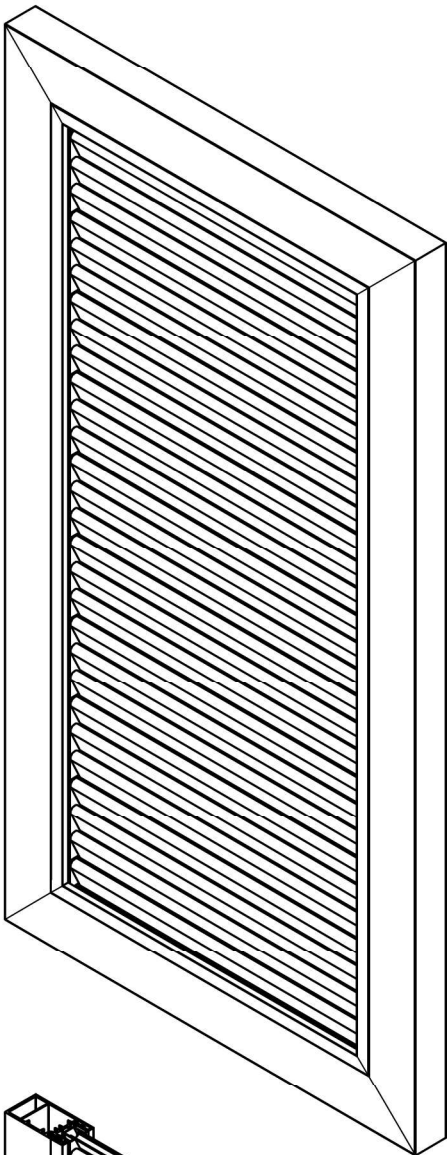



FACTORY

Antalya Organize Sanayi Bölgesi 2.Kısım Mah. 21.Cadde No:3

07040 Döşemealtı / ANTALYA / TURKEY

Tel : +90 242 236 20 00 · Faks : +90 242 236 20 90 · Email : info@ado.com.tr

